

HOODED AND UPBLAST ROOF VENTILATORS

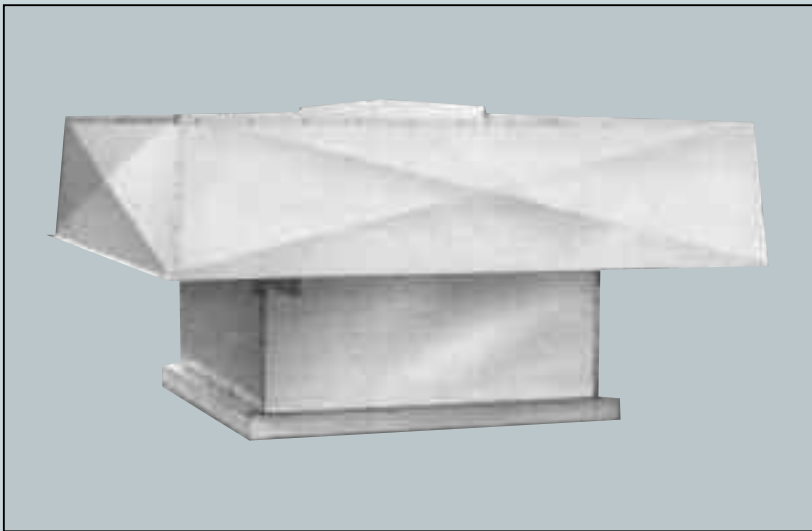

HOODED

- Exhaust or supply
- Capacities to 106,000 CFM
- Static pressures to $3/4$ "WG



UPBLAST

- Belt-drive or direct-drive
- Capacities to 118,000 CFM
- Static pressures to $3/4$ "WG



THE NEW YORK BLOWER COMPANY
7660 Quincy Street
Willowbrook, IL 60527-5530

Visit us on the Web: <http://www.nyb.com>
Phone: (800) 208-7918 Email: nyb@nyb.com

HOODED ROOF VENTILATORS

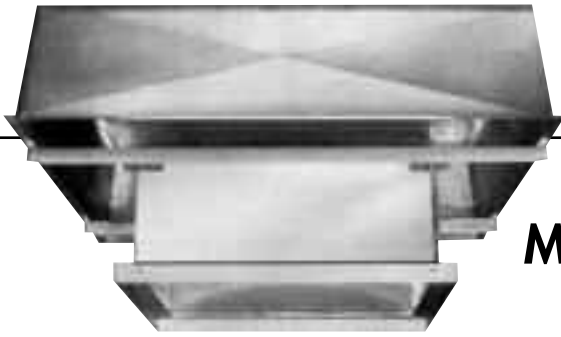

MODELS NYPEB/NYPED/NYPSB/NYPSD

BELT-DRIVE or DIRECT-DRIVE
EXHAUST or SUPPLY

DESIGN FEATURES

- **Nine sizes**—from 24" to 84" in diameter.
- **Airflows**—3000 to 106,000 CFM, up to ¾"SP.
- **Weather-protected**—wide hood overhang for storm protection, weather-tight housing construction.
- **Maintenance**—hood can be pivoted for rooftop access to fan components and ease of service. Large removable panel is supplied for access to the fan and backdraft damper.
- **Field adjustment**—most belt-drive ventilators provide adjustable-pitch sheaves to permit modification to airflow.
- **Filtered supply units**—available in both belt-drive and direct-drive. Contact your New York Blower representative for selection assistance.
- **Motors**—wide selection available.
- **Dimensions and accessories**—dimensions are shown on page 11. Optional accessories are shown on page 10.

CONSTRUCTION FEATURES

- **Hood and base**—heavy-gauge, galvanized steel for rigidity and long life.
- **Finish**—parts requiring coating receive an epoxy powder coating, average 3 mil thickness, baked at 400°F. Impact and chemical resistant.
- **Wheel**—Style H belt-drive units [Size 24-48] use six steel blades. Style C belt-drive units [Size 48-84] and direct-drive units use cast aluminum adjustable-pitch airfoil blades attached to cast-aluminum hub.
- **Bearings and shaft**—Style H belt-drive units [Size 24-48] utilize a fixed shaft design with integral drive/wheel hub assembly and permanently lubricated and sealed bearings with 300,000 hour L10 life. Style C belt-drive units [Size 48-84] have a steel fan shaft supported by two heavy-duty pillow-block ball bearings.
- **Curb cap and support system**—heavy-gauge steel for strength and rigidity.



AMCA SEAL

The New York Blower Company certifies that the Models NYPEB, NYPED, NYPSB, and NYPSD Hooded Roof Ventilators shown herein are licensed to bear the AMCA Seal. The ratings shown are based on tests and procedures performed in accordance with AMCA Publications 211 and 311 and comply with the requirements of the AMCA Certified Ratings Program.

7-PART SIZING NOMENCLATURE

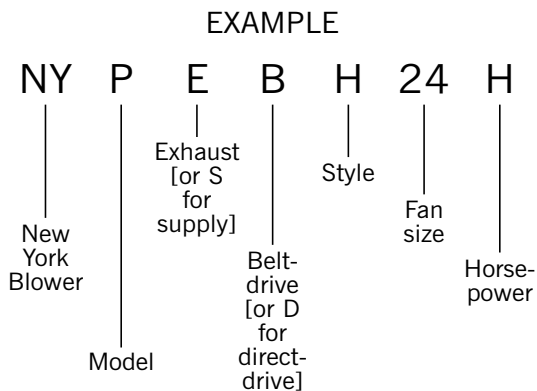

CENTRIFUGAL ROOF EXHAUSTERS



BELT-DRIVE

12 sizes: 6" to 48" diameter
CFM range: 160 to 35,000 CFM
Aluminum BI wheel
Upblast

DIRECT-DRIVE

6 sizes: 6" to 15" diameter
CFM range: 25 to 3250 CFM
Aluminum BI wheel
Upblast and Downblast



Contact your New York Blower representative for additional information.



MODEL NYPEB BELT-DRIVE/EXHAUST performance ratings

Fan		CFM							Motor HP	Fan RPM	Sones at 0"SP	Max. BHP	Apprx. shpg. wt. #
Size	Model	0"SP	1/8"SP	1/4"SP	3/8"SP	1/2"SP	5/8"SP	3/4"SP					
24	NYPEBH24H	5710	4976	4284					1/3	724	19	0.42	330
	NYPEBH24J	6428	5790	5134	4492				1/2	815	24	0.60	335
	NYPEBH24K	7406	6872	6269	5742	5162	3999		3/4	939	32	0.92	350
	NYPEBH24L*	8234	7765	7218	6709	6251	5703	4846	1	1044	40	1.26	355
	NYPEBH24M*	8479	8026	7496	6993	6544	6057	5351	1 1/2	1075	43	1.37	375
30	NYPEBH30H	7613	6278	4754					1/3	551	11	0.42	420
	NYPEBH30J	8594	7426	6103					1/2	622	14.3	0.60	425
	NYPEBH30K	9879	8834	7754	6666				3/4	715	18.7	0.92	445
	NYPEBH30L	10984	10014	9143	8046	7107			1	795	23	1.26	450
	NYPEBH30M	12325	11430	10694	9789	8842	8013		1 1/2	892	28	1.78	480
	NYPEBH30N	13540	12706	12029	11302	10402	9591	8836	2	980	32	2.36	485
	NYPEBH30P	15530	14779	14158	13581	12925	12143	11374	3	1124	41	3.52	515
36	NYPEBH36K	12455	10864	9085					3/4	528	17.6	0.92	498
	NYPEBH36L	13752	12343	10757	8867				1	583	20	1.26	520
	NYPEBH36M	15404	14173	12763	11328	9284			1 1/2	653	24	1.77	550
	NYPEBH36N	16890	15782	14521	13232	11839	9444		2	716	28	2.30	555
	NYPEBH36P	19343	18391	17337	16200	15081	13886	12348	3	820	37	3.50	585
42	NYPEBH42J	13009	10070	7228					1/2	381	14.5	0.60	641
	NYPEBH42K	14955	12363	9917					3/4	438	18.2	0.92	646
	NYPEBH42L	16594	14219	11992	9897				1	486	22	1.25	668
	NYPEBH42M	18609	16451	14498	12513	10590			1 1/2	545	27	1.77	697
	NYPEBH42N	20316	18316	16521	14677	12968	10907		2	595	32	2.30	700
	NYPEBH42P	23150	21368	19752	18189	16556	15054	13534	3	678	43	3.41	730
48	NYPEBH48K	16365	13048	9586					3/4	349	17	0.92	840
	NYPEBH48L	18193	15232	12030					1	388	20	1.26	845
	NYPEBH48M	20163	17442	14466	11924				1 1/2	430	24	1.72	902
	NYPEBH48N	22226	19698	17247	14664	11969			2	474	28	2.30	905
	NYPEBH48P	25415	23126	21180	18658	16623	14411		3	542	36	3.44	950
	NYPEBC48Q	29654	27996	26173	24355	22456	20189	18023	5	769	48	5.61	1160
	NYPEBC48R	34011	32582	31043	29420	27851	26231	24284	7 1/2	882	62	8.46	1215
	NYPEBC48S	37482	36193	34825	33372	31904	30493	29022	10	972	77	11.33	1265
54	NYPEBC54N	24993	22008	18753	14589				2	515	26	2.16	1235
	NYPEBC54P	28826	26321	23336	20483	16795			3	594	32	3.31	1260
	NYPEBC54Q	34359	32294	29972	27470	25217	21972	18949	5	708	42	5.62	1290
	NYPEBC54R	39454	37672	35774	33560	31463	29572	26876	7 1/2	813	54	8.51	1350
	NYPEBC54S	43482	41873	40187	38345	36237	34438	32728	10	896	68	11.38	1380
60	NYPEBC60P	32303	28588	24375	19208				3	513	37	3.27	1385
	NYPEBC60Q	38600	35316	32287	28596	24180	20125		5	613	48	5.58	1415
	NYPEBC60R	44330	41312	38938	35894	32698	28887	25137	7 1/2	704	58	8.46	1475
	NYPEBC60S	48864	46025	43874	41455	38517	35617	32122	10	776	68	11.33	1510
72	NYPEBC72N	35689	28471	21081					2	304	19.9	2.30	1732
	NYPEBC72P	40855	34641	27988	22192				3	348	26	3.45	1754
	NYPEBC72Q	48368	43111	37634	32108	27088			5	412	34	5.71	1769
	NYPEBC72R	55412	50794	46229	41206	36497	31988	28562	7 1/2	472	40	8.60	1826
	NYPEBC72S	60930	56711	52605	48214	43643	39444	35341	10	519	46	11.43	1857
	NYPEBC72T*	69852	66153	62565	58944	55044	51026	47298	15	595	60	17.24	1928
	NYPEBC72U*	76896	73527	70246	67000	63638	60033	56381	20	655	75	22.99	1962
84	NYPEBC84P	49927	40472	30631					3	269	21	3.42	2277
	NYPEBC84Q	59393	51528	43071	35136				5	320	29	5.75	2302
	NYPEBC84R	67930	61026	53942	46553	39704	34522		7 1/2	366	39	8.59	2352
	NYPEBC84S	74797	68498	62263	55404	48998	42888	38279	10	403	45	11.49	2390
	NYPEBC84T	85562	80022	74642	68983	62935	57327	51806	15	461	54	17.19	2463
	NYPEBC84U*	94100	89045	84140	79183	73828	68350	63283	20	507	61	22.88	2497

* These models have fixed-pitch motor pulley.

- Performance shown is for installation Type A: Free Inlet, Free Outlet. Performance ratings do not include the effects of appurtenances in the airstream. Power rating [BHP] does not include drive losses.
- On Style H, die-formed steel blades are standard. On Style C, an adjustable-pitch propeller with cast-aluminum airfoil blades is standard.
- The sound ratings shown are loudness values in fan sones at 5 ft. [1.5m] in a hemispherical free field calculated per AMCA Standard 301. Values shown are for installation Type A: Free Inlet fan-sones levels. The sound ratings shown are at 0" static pressure.
- BHP at most static pressures listed is less than that shown. Motor loading beyond the nominal nameplate rating does not overheat the motor and is within NEMA-recommended limits and motor service factor due to the moving airstream.



MODEL NYPED DIRECT-DRIVE/EXHAUST performance ratings

Fan		CFM							Motor HP	Fan RPM	Sones at 0"SP	Max. BHP	Wheel		Apprx. shpg. wt. #
Size	Model	0"SP	1/8"SP	1/4"SP	3/8"SP	1/2"SP	5/8"SP	3/4"SP					No. blades	Pitch	
24	NYPEDC24G8	5199	4270	3026					1/4	870	12.4	0.29	3	27 1/2	375
	NYPEDC24J8	6308	5660	4830	3235				1/2	870	15.3	0.57	6	30 1/2	385
	NYPEDC24H11	5267	4744	4010	3023				1/3	1160	17.3	0.38	3	16	370
	NYPEDC24J11	6407	5772	5073	4226				1/2	1160	18.4	0.58	3	23	380
	NYPEDC24K11	6827	6344	5878	5300	4483	3433		3/4	1160	21	0.87	6	22 1/2	385
	NYPEDC24L11	7721	7309	6807	6228	5457	4181		1	1160	23	1.13	6	27	396
	NYPEDC24L17	7446	7099	6751	6256	5757	5216	4530	1	1750	32	1.13	3	14	385
	NYPEDC24M17	8936	8551	8108	7663	7211	6727	6163	1 1/2	1750	34	1.70	3	19 1/2	390
	NYPEDC24N17	10315	9888	9436	8968	8491	8000	7468	2	1750	40	2.26	3	26 1/2	396
	NYPEDC24P17	11180	10912	10615	10296	9966	9631	9278	3	1750	43	3.48	6	25	426
30	NYPEDC30J8	8799	7557	5999					1/2	870	15.7	0.58	3	22 1/2	500
	NYPEDC30L11	11004	10057	9134	8062	6377			1	1160	24	1.14	3	19 1/2	515
	NYPEDC30M11	11552	10959	10347	9667	8951	8099	6911	1 1/2	1160	28	1.72	6	16 1/2	545
	NYPEDC30N11	13417	12870	12319	11730	11037	10160	8984	2	1160	29	2.24	6	20 1/2	560
	NYPEDC30N17	12928	12315	11733	11134	10511	9847	9066	2	1750	45	2.25	3	12	510
	NYPEDC30P17	15430	14779	14247	13657	13009	12332	11616	3	1750	47	3.39	3	17	535
	NYPEDC30Q17	18894	18253	17593	16941	16304	15658	14969	5	1750	57	5.68	3	25 1/2	550
	36	NYPEDC36L6	14419	12695	10888					1	680	24	1.13	6	23 1/2
NYPEDC36M6		16667	14966	12426	8820				1 1/2	680	23	1.67	6	30	670
NYPEDC36L8		13246	11916	10505	8867				1	870	27	1.14	4	15 1/2	615
NYPEDC36M8		15155	14031	13060	11896	10392			1 1/2	870	30	1.72	6	17	620
NYPEDC36N8		17957	16609	15341	13986	12343			2	870	34	2.26	6	22 1/2	670
NYPEDC36P8		21108	19857	18265	16286	14154			3	870	34	3.41	6	29 1/2	690
NYPEDC36M11		15024	13680	12458	11157	9623			1 1/2	1160	36	1.70	3	12 1/2	615
NYPEDC36N11		17420	15993	14568	12990	11694	9682		2	1160	38	2.23	3	17	620
NYPEDC36P11		18493	17850	17169	16442	15623	14766	13765	3	1160	55	3.41	6	14 1/2	670
NYPEDC36Q11		24598	23676	22546	21569	20565	19503	18358	5	1160	66	5.66	6	23 1/2	690
NYPEDC36Q17		20857	20050	19269	18508	17758	17005	16237	5	1750	82	5.56	3	10 1/2	620
NYPEDC36R17		26045	25075	24202	23350	22517	21697	20884	7 1/2	1750	90	8.52	3	16 1/2	670
NYPEDC36S17	29682	28825	27918	26960	25967	24966	23981	10	1750	90	11.19	3	20 1/2	690	
42	NYPEDC42L6	14634	12779	10690					1	680	20	1.15	4	15	740
	NYPEDC42M6	16567	15226	13702	11353				1 1/2	680	28	1.69	6	16	790
	NYPEDC42N6	18561	17169	15627	13724				2	680	29	2.29	6	21 1/2	810
	NYPEDC42M8	16196	14851	13266	11409	8995			1 1/2	870	30	1.69	4	10	740
	NYPEDC42N8	18209	16770	15267	13625	11501			2	870	31	2.25	4	14	790
	NYPEDC42P8	20950	19926	18856	17655	16185	14079	10949	3	870	44	3.42	6	15 1/2	810
	NYPEDC42N11	17357	16029	14646	13233	11627	9352		2	1160	46	2.29	3	6	740
	NYPEDC42P11	20749	19518	18250	16849	15168	13180	11018	3	1160	52	3.43	3	11	790
	NYPEDC42Q11	24963	23914	22828	21695	20516	19297	17991	5	1160	50	5.70	4	15	810
	NYPEDC42R17	27260	26425	25550	24641	23697	22725	21741	7 1/2	1750	104	8.57	3	7	790
	NYPEDC42S17	30821	30024	29227	28417	27582	26709	25784	10	1750	127	11.35	3	10 1/2	810
48	NYPEDC48L6	15099	12927	10890					1	680	30	1.14	4	5 1/2	970
	NYPEDC48M6	17813	15769	13435	10336				1 1/2	680	28	1.70	4	11	1010
	NYPEDC48N6	19624	18033	16294	14063	10852			2	680	33	2.26	6	10 1/2	1035
	NYPEDC48N8	19147	17118	15145	12820	9784			2	870	46	2.22	3	8	1010
	NYPEDC48P8	22555	20991	19266	17449	15381	12675		3	870	42	3.45	4	10 1/2	1030
	NYPEDC48Q8	27053	25833	24536	23123	21544	19682	17321	5	870	55	5.73	6	13 1/2	1075
	NYPEDC48R8	30441	29167	27873	26478	24911	23144	21137	7 1/2	870	61	8.67	6	21	1150
	NYPEDC48Q11	25757	24577	23296	21929	20653	19515	18357	5	1160	79	5.65	4	5 1/2	1030
	NYPEDC48R11	30388	29254	28056	26784	25454	24086	22652	7 1/2	1160	74	8.44	4	11	1065
	NYPEDC48S11	33476	32563	31628	30675	29697	28679	27595	10	1160	91	11.24	6	10 1/2	1105
54	NYPEDC54M6	22231	19176	16357	12815				1 1/2	680	35	1.70	4	5 1/2	1150
	NYPEDC54N6	24570	21788	18548	15035				2	680	36	2.22	4	8 1/2	1170
	NYPEDC54P8	27955	25646	22906	19868	16442			3	870	60	3.31	3	7 1/2	1165
	NYPEDC54Q8	32057	30418	28921	27440	25709	23480	21146	5	870	74	5.56	6	6 1/2	1215
	NYPEDC54R8	38693	37092	35589	34057	32325	30218	27855	7 1/2	870	68	8.51	6	12 1/2	1245
	NYPEDC54R11	37923	36192	34319	32563	30963	29356	27561	7 1/2	1160	91	8.46	4	5 1/2	1205
	NYPEDC54S11	41913	40175	38626	37018	35260	33301	31278	10	1160	93	11.03	4	8 1/2	1235
60	NYPEDC60N6	26423	22665	18847					2	680	41	2.28	3	6	1350
	NYPEDC60Q8	35829	33345	30394	26778	23715	18723		5	870	64	5.63	3	8	1390
	NYPEDC60R8	40945	39359	37776	36093	34201	32070	29691	7 1/2	870	78	8.58	6	6	1440

See page 5 for performance-table notes.



MODEL NYPSB BELT-DRIVE/SUPPLY performance ratings

Fan		CFM							Motor HP	Fan RPM	Sones at 0"SP	Max. BHP	Apprx. shpg. wt. #
Size	Model	0"SP	1/8"SP	1/4"SP	3/8"SP	1/2"SP	5/8"SP	3/4"SP					
24	NYPSBH24H	5910	5301	4009					1/3	733	19.7	0.46	330
	NYPSBH24J	6539	6019	4979	3347				1/2	811	24	0.60	335
	NYPSBH24K	7475	7004	6258	5306				3/4	927	32	0.92	350
	NYPSBH24L*	8281	7838	7398	6475	5526			1	1027	37	1.26	355
	NYPSBH24M*	8668	8237	7866	7001	6185	4823		1 1/2	1075	39	1.43	375
30	NYPSBH30H	7684	6148						1/3	545	14	0.40	420
	NYPSBH30J	8924	7835	5714					1/2	633	19.6	0.67	425
	NYPSBH30K	9911	9005	7275	5503				3/4	703	23	0.92	445
	NYPSBH30L	10997	10208	8875	7094	5508			1	780	27	1.26	450
	NYPSBH30M	12308	11617	10675	9183	7637	6187		1 1/2	873	33	1.77	480
	NYPSBH30N	13506	12884	12149	10923	9443	8177	6828	2	958	40	2.34	485
	NYPSBH30P	15734	15208	14634	13916	12803	11605	10298	3	1116	57	3.68	515
36	NYPSBH36H	9994	6584						1/3	396	12.7	0.42	487
	NYPSBH36J	11180	8365						1/2	443	15.9	0.56	493
	NYPSBH36K	12946	10944	7381					3/4	513	20	0.91	498
	NYPSBH36L	14435	12771	9765					1	572	24	1.25	520
	NYPSBH36M	16076	14648	12240	9445				1 1/2	637	28	1.75	550
	NYPSBH36N	17691	16431	14653	11976	8970			2	701	33	2.31	555
	NYPSBH36P	20139	19063	17734	15695	13396	10964		3	798	43	3.43	585
42	NYPSBH42K	15097	12705	8562					3/4	434	20	0.92	646
	NYPSBH42L	16732	14770	11391					1	481	24	1.24	668
	NYPSBH42M	18610	16980	14236	10723				1 1/2	535	28	1.72	697
	NYPSBH42N	20558	19156	16923	14057				2	591	34	2.30	700
	NYPSBH42P	23410	22234	20579	18311	15703	12539		3	673	42	3.41	730
48	NYPSBH48L	20924	16752	10857					1	382	25	1.25	845
	NYPSBH48M	23498	19928	14683					1 1/2	429	30	1.78	902
	NYPSBH48N	25634	22374	17848	13311				2	468	35	2.30	905
	NYPSBH48P	29359	26481	23381	18819	14965			3	536	45	3.47	950
	NYPSBC48Q	32073	30305	28275	25612	22119	17213		5	940	66	5.59	1160
	NYPSBC48R	36850	35333	33663	31768	29303	26093	23230	7 1/2	1080	85	8.48	1215
	NYPSBC48S	40603	39237	37763	36150	34303	31862	28911	10	1190	103	11.35	1265
54	NYPSBC54N	27987	23691	17519					2	584	41	2.29	1235
	NYPSBC54P	32012	28566	23826	17067				3	668	51	3.42	1260
	NYPSBC54Q	38002	35467	31560	27486	21821			5	793	70	5.72	1290
	NYPSBC54R	43514	41444	38284	34852	31204	26343		7 1/2	908	95	8.59	1350
	NYPSBC54S	47731	45902	43314	40120	36996	33518	28976	10	996	114	11.34	1380
60	NYPSBC60N	30768	25953	18427					2	549	42	2.30	1360
	NYPSBC60P	35251	31282	25826	18036				3	629	52	3.45	1385
	NYPSBC60Q	41752	38634	34578	29252	22868			5	745	69	5.74	1415
	NYPSBC60R	47805	45186	41834	38231	33095	27652		7 1/2	853	89	8.61	1475
	NYPSBC60S	52624	50291	47442	44148	40730	35643	30752	10	939	110	11.48	1510
72	NYPSBC72N	40092	34163	27135					2	308	26	2.18	1732
	NYPSBC72P	46080	41207	35450	24115				3	354	33	3.32	1754
	NYPSBC72Q	54671	50648	45845	41225	33973			5	420	44	5.52	1769
	NYPSBC72R	62611	59087	55343	50869	46951	41423		7 1/2	481	56	8.32	1826
	NYPSBC72S	69119	65910	62707	58781	54919	51359	46405	10	531	67	11.18	1857
	NYPSBC72T*	79142	76321	73583	70611	67060	63641	60576	15	608	87	16.80	1928
	NYPSBC72U*	87083	84511	82018	79471	76565	73267	70178	20	669	105	22.38	1962
84	NYPSBC84P	56251	48472	39689					3	274	28	3.29	2277
	NYPSBC84Q	66722	60560	53058	45028				5	325	38	5.50	2302
	NYPSBC84R	76576	71270	64949	58776	51127			7 1/2	373	48	8.30	2352
	NYPSBC84S	84377	79562	74283	68166	62802	54650		10	411	58	11.13	2390
	NYPSBC84T	96695	92475	88221	83069	77830	73204	67602	15	471	74	16.74	2463
	NYPSBC84U*	106549	102706	98920	94708	89729	85154	80971	20	519	89	22.37	2497

* These models have fixed-pitch motor pulley. Note: For performance ratings with filters, see Engineering Supplement ES-753.

- Performance shown is for installation Type A: Free Inlet, Free Outlet. Performance ratings do not include the effects of appurtenances in the airstream. Power rating [BHP] does not include drive losses.
- On Style H, die-formed steel blades are standard. On Style C, an adjustable-pitch propeller with cast-aluminum airfoil blades is standard.
- The sound ratings shown are loudness values in fan sones at 5 ft. [1.5m] in a hemispherical free field calculated per AMCA Standard 301. Values shown are for installation Type A: Free Inlet fan-sone levels. The sound ratings shown are at 0" static pressure.
- BHP at most static pressures listed is less than that shown. Motor loading beyond the nominal nameplate rating does not overheat the motor and is within NEMA-recommended limits and motor service factor due to the moving airstream.



MODEL NYPSD DIRECT-DRIVE/SUPPLY performance ratings

Fan		CFM							Motor HP	Fan RPM	Sones at 0"SP	Max. BHP	Wheel		Apprx. shpg. wt. #
Size	Model	0"SP	1/8"SP	1/4"SP	3/8"SP	1/2"SP	5/8"SP	3/4"SP					No. blades	Pitch	
24	NYPSDC24G8	5407	4437	3186					1/4	870	14.5	0.29	3	27 1/2	375
	NYPSDC24J8	6512	5871	5048	3421				1/2	870	17.8	0.58	6	30 1/2	385
	NYPSDC24H11	5324	4788	4043	3041				1/3	1160	19.7	0.37	3	15 1/2	370
	NYPSDC24J11	6648	5978	5251	4388				1/2	1160	22	0.57	3	23	380
	NYPSDC24K11	6985	6499	6038	5466	4674	3538		3/4	1160	27	0.86	6	22 1/2	385
	NYPSDC24L11	7984	7524	7037	6450	5716	4420		1	1160	28	1.13	6	27	396
	NYPSDC24L17	7629	7255	6897	6447	5909	5364	4676	1	1750	37	1.13	3	14	385
	NYPSDC24M17	9215	8819	8390	7909	7431	6939	6376	1 1/2	1750	43	1.70	3	19 1/2	390
	NYPSDC24N17	10714	10287	9821	9327	8819	8301	7758	2	1750	48	2.26	3	26 1/2	396
	NYPSDC24P17	11458	11206	10926	10613	10272	9922	9564	3	1750	53	3.44	6	25	426
30	NYPSDC30J8	9062	7728	6172					1/2	870	20	0.56	3	22	525
	NYPSDC30K8	9808	9053	8184	6971				3/4	870	22	0.85	6	19	515
	NYPSDC30L8	11227	10411	9539	8439	6440			1	870	23	1.14	6	23 1/2	545
	NYPSDC30K11	9683	8849	7834	6715				3/4	1160	29	0.83	3	14 1/2	500
	NYPSDC30L11	11378	10427	9417	8343	6723			1	1160	32	1.14	3	19 1/2	515
	NYPSDC30M11	13174	12169	11087	9984	8464			1 1/2	1160	34	1.70	3	26	545
	NYPSDC30N11	13967	13376	12787	12183	11512	10677	9540	2	1160	37	2.32	6	21	560
	NYPSDC30N17	13236	12673	12020	11401	10759	10084	9317	2	1750	57	2.25	3	12	510
	NYPSDC30P17	15897	15284	14641	14061	13411	12707	11973	3	1750	60	3.39	3	17	535
	NYPSDC30Q17	19686	19039	18348	17631	16924	16239	15540	5	1750	69	5.68	3	25 1/2	550
36	NYPSDC36L6	14757	13009	11160	7671				1	680	25	1.13	6	23 1/2	625
	NYPSDC36M6	17100	15492	12951	9606				1 1/2	680	28	1.67	6	30	670
	NYPSDC36K8	12797	10909	9036					3/4	870	27	0.86	3	15 1/2	585
	NYPSDC36L8	14658	12720	10302	7771				1	870	30	1.15	3	20	615
	NYPSDC36M8	17190	15217	12852	9524				1 1/2	870	33	1.72	3	28	620
	NYPSDC36N8	18486	17018	15265	12845				2	870	38	2.29	4	28 1/2	670
	NYPSDC36M11	15355	13951	12675	11357	9812			1 1/2	1160	41	1.70	3	12 1/2	615
	NYPSDC36N11	18162	16694	15212	13477	12068	10179		2	1160	48	2.30	3	17 1/2	620
	NYPSDC36P11	21454	20015	18344	16757	14752	12688		3	1160	55	3.43	3	24	670
	NYPSDC36Q11	25174	24310	23187	22100	21066	19984	18823	5	1160	66	5.64	6	23 1/2	690
	NYPSDC36Q17	21704	20866	20035	19227	18436	17649	16850	5	1750	84	5.80	3	11	620
	NYPSDC36R17	26714	25812	24795	23888	23005	22143	21293	7 1/2	1750	94	8.52	3	16 1/2	670
	NYPSDC36S17	30528	29664	28753	27784	26759	25701	24644	10	1750	103	11.19	3	20 1/2	690
42	NYPSDC42M6	18243	15747	13417	10487				1 1/2	680	31	1.69	4	21 1/2	790
	NYPSDC42N6	19775	18182	16587	14691				2	680	39	2.28	6	21 1/2	810
	NYPSDC42L8	14842	13024	10814	8219				1	870	36	1.14	3	8	730
	NYPSDC42M8	17913	15819	13743	11211				1 1/2	870	40	1.69	3	13	740
	NYPSDC42N8	20401	18309	16043	13512				2	870	44	2.27	3	17 1/2	790
	NYPSDC42P8	23768	21565	18951	16101	13216			3	870	55	3.43	3	25	810
	NYPSDC42N11	18271	16867	15365	13836	12192	9908		2	1160	57	2.29	3	6	740
	NYPSDC42P11	22117	20672	19290	17848	16179	14064	11695	3	1160	66	3.43	3	11	790
	NYPSDC42Q11	27552	25988	24370	22684	20900	18993	16881	5	1160	76	5.53	3	18	810
	NYPSDC42R17	28702	27799	26928	25974	24981	23943	22870	7 1/2	1750	129	8.57	3	7	790
NYPSDC42S17	32747	31806	30897	30005	29114	28208	27264	10	1750	143	11.35	3	10 1/2	810	
48	NYPSDC48L6	17093	14028	10788					1	680	30	1.13	3	8 1/2	970
	NYPSDC48M6	19790	17500	14871	11665				1 1/2	680	37	1.70	4	11	1010
	NYPSDC48N6	22032	19398	16929	14021				2	680	36	2.24	4	15	1035
	NYPSDC48N8	21486	19149	16627	14183	10881			2	870	46	2.26	3	8	1010
	NYPSDC48P8	25665	23195	20745	18107	14961			3	870	51	3.40	3	13 1/2	1030
	NYPSDC48Q8	29842	27837	25628	23258	20941	18497		5	870	60	5.48	4	17 1/2	1075
	NYPSDC48R8	34926	32979	31138	29520	27936	26187	24113	7 1/2	870	76	8.63	6	20 1/2	1105
	NYPSDC48Q11	29158	27430	25659	23758	21888	20074	17993	5	1160	80	5.59	3	8 1/2	1030
	NYPSDC48R11	35320	33424	31545	29660	27772	25839	23714	7 1/2	1160	90	8.63	3	14 1/2	1065
	NYPSDC48S11	38809	37016	35207	33263	30914	28145	25590	10	1160	96	11.33	3	19	1105
54	NYPSDC54P8	30602	27598	24841	21411	17756			3	870	61	3.34	3	7 1/2	1165
	NYPSDC54Q8	37058	34720	30902	27388	24784			5	870	73	5.47	3	14	1215
	NYPSDC54R8	44529	41427	36242	32007	28931	23941		7 1/2	870	88	8.58	3	22	1245
	NYPSDC54R11	41536	39288	36990	35026	32887	30321	27551	7 1/2	1160	105	8.28	3	8	1205
	NYPSDC54S11	47000	45147	42737	39724	37354	35456	33506	10	1160	117	11.29	3	12	1235
60	NYPSDC60N6	28242	24846	19859					2	680	49	2.29	3	6	1350
	NYPSDC60Q8	38741	35829	32945	29122	25259	20963		5	870	80	5.72	3	8	1390
	NYPSDC60R8	45697	42506	39505	35400	29872	24571		7 1/2	870	90	8.53	3	14	1440
	NYPSDC60S11	48177	46171	44282	42167	38955	35716	33497	10	1160	137	11.37	3	6	1440

See page 5 for performance-table notes. Note: For performance ratings with filters, see Engineering Supplement ES-752.

UPBLAST ROOF VENTILATORS



MODELS NYJBH/NYJBHX/NYJBC/NYJDC BELT-DRIVE or DIRECT-DRIVE

DESIGN FEATURES

- **Ten sizes**—from 18" to 84" in diameter.
- **Airflows**—2300 to 118,000 CFM, up to ¾"SP.
- **Materials**—housing and curb cap are constructed of heavy-gauge steel. Dampers are of translucent FRP. Wind shroud is galvanized steel.
- **Coating**—parts requiring coating receive an epoxy powder coating, average 3 mil thickness, baked at 400°F. Impact and chemical-resistant.
- **Field adjustment**—most belt-drive ventilators provide adjustable-pitch sheaves to permit modification to airflow.
- **Dimensions and accessories**—dimensions are shown on page 11. Optional accessories are shown on page 10.
- **Bearings and shaft**—Models NYJBH and NYJBHX utilize a fixed shaft design with integral drive/wheel hub assembly and permanently lubricated and sealed bearings with 300,000 hour L10 life. Model NYJBC utilizes a steel fan shaft supported by two heavy-duty pillow-block ball bearings.



AMCA SEAL

The New York Blower Company certifies that the Models NYJBH, NYJBHX, NYJBC, and NYJDC Upblast Roof Ventilators shown herein are licensed to bear the AMCA Seal. The ratings shown are based on tests and procedures performed in accordance with AMCA Publications 211 and 311 and comply with the requirements of the AMCA Certified Ratings Program.

6-PART SIZING NOMENCLATURE

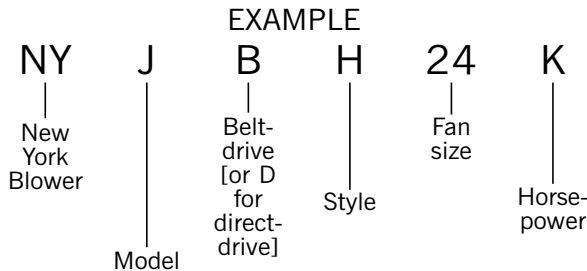

UPBLAST MODEL NYJBH BELT-DRIVE performance ratings

Fan		CFM					Motor HP	Fan RPM	Sones at 0"SP	Max. BHP	Apprx. shpg. wt. #
Size	Model	0"SP	¼"SP	½"SP	¾"SP	1"SP					
24	NYJBH24K	7901	7251	6564			¾	949	31	0.91	240
	NYJBH24L*	8725	8136	7537	6860		1	1048	38	1.25	242
	NYJBH24M*	8950	8375	7795	7143	6484	1½	1075	40	1.39	282
30	NYJBH30L	11780	10761	9724			1	798	26	1.25	315
	NYJBH30M	13094	12177	11255	10279		1½	887	31	1.76	335
	NYJBH30N	14245	13402	12559	11692	10727	2	965	36	2.30	340
	NYJBH30P*	16430	15698	14969	14234	13478	3	1113	48	3.41	362
36	NYJBH36L	15425	13849				1	607	23	1.25	367
	NYJBH36M	17026	15560	14082			1½	670	27	1.76	385
	NYJBH36N	18423	17050	15774	14162		2	725	31	2.30	390
	NYJBH36P	20990	19804	18688	17417	15989	3	826	38	3.41	412
42	NYJBH42M	20363	18347	15703			1½	533	27	1.77	470
	NYJBH42N	22121	20263	18007	15759		2	579	31	2.30	475
	NYJBH42P	25177	23538	21857	19534	17737	3	659	38	3.40	500
48	NYJBH48N	26870	23995	20378			2	469	29	2.30	620
	NYJBH48P	30537	28038	25086	21687		3	533	35	3.41	640

* These models have fixed-pitch motor pulley.

- Performance shown is for installation Type A: Free Inlet, Free Outlet. Performance ratings do not include the effects of appurtenances in the airstream. Power rating [BHP] does not include drive losses.
- Formed steel blades are standard.
- The sound ratings shown are loudness values in fan sones at 5 ft. [1.5m] in a hemispherical free field calculated per AMCA Standard 301. Values shown are for installation Type A: Free Inlet fan-sones levels. The sound ratings shown are at 0" static pressure.
- BHP at most static pressures listed is less than that shown. Motor loading beyond the nominal nameplate rating does not overheat the motor and is within NEMA-recommended limits and motor service factor due to the moving airstream.

UPBLAST MODEL NYJBHX BELT-DRIVE performance ratings

Fan		CFM				Motor HP	Fan RPM	Sones at 0"SP	Max. BHP	Apprx. shpg. wt. #
Size	Model	0"SP	1/8"SP	1/4"SP	3/8"SP					
48	NYJBHX48Q*	34935	32753	30116	27709	5	628	49	5.53	730
	NYJBHX48R*	39941	38087	35864	33602	7½	718	64	8.08	810
	NYJBHX48S*	44948	43330	41462	39381	10	808	80	11.28	850
54	NYJBHX54P	34860	30475	24974		3	431	35	3.36	812
	NYJBHX54Q	41331	37704	33710	28614	5	511	48	5.60	847
	NYJBHX54R*	47154	44024	40640	36818	7½	583	63	8.29	912
	NYJBHX54S*	52250	49450	46434	43286	10	646	74	11.19	947
60	NYJBHX60P	41102	35761	28343		3	404	35	3.38	982
	NYJBHX60Q	49343	44430	40253	33354	5	485	50	5.86	992
	NYJBHX60R	55651	50984	47860	42451	7½	547	64	8.31	1067
	NYJBHX60S*	62060	57646	54767	51427	10	610	77	11.41	1097

UPBLAST MODEL NYJBC BELT-DRIVE performance ratings

Fan		CFM							Motor HP	Fan RPM	Sones at 0"SP	Max. BHP	Apprx. shpg. wt. #
Size	Model	0"SP	1/8"SP	1/4"SP	3/8"SP	1/2"SP	5/8"SP	3/4"SP					
48	NYJBC48Q	36718	33485	30577	27508	24084	19103		5	921	58	5.55	740
	NYJBC48R	41940	39062	36468	33912	31180	28230	24467	7½	1052	77	8.27	820
	NYJBC48S	46126	43483	41073	38774	36396	33876	31187	10	1157	92	11.01	860
54	NYJBC54P	35856	30903	25556					3	665	37	3.40	840
	NYJBC54Q	42650	38520	34180	29699	23670			5	791	51	5.76	875
	NYJBC54R	48527	44914	41188	37156	33362	28244		7½	900	65	8.52	940
	NYJBC54S	53164	49874	46500	43004	39225	35848	30950	10	986	76	11.20	975
60	NYJBC60Q	49547	44999	38811	32840	25776			5	749	48	5.62	1025
	NYJBC60R	56559	52717	47801	42037	37086	31091		7½	855	61	8.36	1100
	NYJBC60S	62182	58754	54585	49509	44375	40102	34498	10	940	72	11.12	1130
72	NYJBC72P	51821	45695	38302					3	358	26	3.45	1424
	NYJBC72Q	61374	56274	50728	44054	37382			5	424	34	5.73	1439
	NYJBC72R	70204	65780	61116	55927	49971	44475		7½	485	42	8.57	1478
	NYJBC72S*	77441	73447	69286	64873	59817	54461	49532	10	535	50	11.49	1505
	NYJBC72T*	88587	85108	81530	77821	73907	69539	64743	15	612	64	17.19	1633
	NYJBC72U*	96838	93661	90414	87073	83619	79960	75907	20	669	76	22.44	1657
84	NYJBC84Q	75290	67574	58702	48956				5	329	30	5.74	1716
	NYJBC84R	86274	79607	72437	63858	55576			7½	377	38	8.60	1755
	NYJBC84S	94741	88702	82329	75211	67096	59517		10	414	45	11.42	1782
	NYJBC84T	108701	103465	98031	92316	85944	78778	72342	15	475	56	17.23	1910
	NYJBC84U*	118770	113990	109069	103961	98546	92452	85882	20	519	65	22.45	1934

* These models have fixed-pitch motor pulley.

- Performance shown is for installation Type A: Free Inlet, Free Outlet. Performance ratings do not include the effects of appurtenances in the airstream. Power rating [BHP] does not include drive losses.
- Formed steel blades are standard on Model NYJBHX. Adjustable-pitch aluminum blades are standard on Model NYJBC.
- The sound ratings shown are loudness values in fan sones at 5 ft. [1.5m] in a hemispherical free field calculated per AMCA Standard 301. Values shown are for installation Type A: Free Inlet fan-sones levels. The sound ratings shown are at 0" static pressure.
- BHP at most static pressures listed is less than that shown. Motor loading beyond the nominal nameplate rating does not overheat the motor and is within NEMA-recommended limits and motor service factor due to the moving airstream.



HIGH-PRESSURE UPBLAST ROOF EXHAUSTERS—Belt-drive or direct-drive

	DUCT FAN	TUBEAXIAL FAN	VANEAXIAL FAN
CAPACITIES TO:	56,000 CFM	86,000 CFM	100,000 CFM
PRESSURES TO:	2"WG	3"WG	5"WG
13 SIZES:	12"-60"	12"-60"	12"-60"

UP BLAST MODEL NYJDC DIRECT-DRIVE performance ratings

Fan		CFM							Motor HP	Fan RPM	Sones at 0"SP	Max. BHP	Wheel*		Apprx. shpg. wt. #
Size	Model	0"SP	1/8"SP	1/4"SP	3/8"SP	1/2"SP	5/8"SP	3/4"SP					No. blades	Pitch	
18	NYJDC18G17	3274	2978	2653	2314				1/4	1750	16.4	0.30	3	14 1/2	112
	NYJDC18H17	3658	3347	3006	2655				1/3	1750	17.1	0.37	3	18	115
	NYJDC18J17	4408	4061	3718	3273	2889	2328		1/2	1750	20	0.58	3	25 1/2	118
	NYJDC18K17	4912	4631	4309	3959	3588	3240		3/4	1750	23	0.86	4	29	127
	NYJDC18L17	5225	5048	4813	4537	4289	4003		1	1750	22	1.15	6	29 1/2	136
24	NYJDC24K11	7025	6461	5858	5115				3/4	1160	25	0.85	4	27	280
	NYJDC24L11	7533	7106	6602	6024	5215			1	1160	23	1.13	6	27	291
	NYJDC24K17	6677	6238	5775	5321				3/4	1750	39	0.88	3	11 1/2	265
	NYJDC24L17	7425	7108	6749	6261	5784	5264		1	1750	39	1.18	3	14 1/2	265
	NYJDC24M17	8817	8431	8019	7583	7132	6658	6114	1 1/2	1750	38	1.76	3	20	291
	NYJDC24N17	10021	9601	9166	8722	8268	7790	7259	2	1750	46	2.31	3	27	291
NYJDC24P17	11339	10981	10577	10131	9667	9194	8705	3	1750	49	3.38	4	30 1/2	318	
30	NYJDC30L8	10693	9913	9057	7900				1	870	21	1.11	6	23	407
	NYJDC30L11	10920	9979	9071	7998				1	1160	26	1.14	3	19 1/2	380
	NYJDC30M11	12207	11478	10693	9810	8734			1 1/2	1160	30	1.70	4	22	407
	NYJDC30N11	13787	12920	12010	11127	10133	8726		2	1160	32	2.27	4	27	418
	NYJDC30N17	12859	12245	11669	11074	10455	9793	9007	2	1750	47	2.25	3	12	380
	NYJDC30P17	15292	14693	14157	13565	12920	12250	11535	3	1750	49	3.39	3	17	407
	NYJDC30Q17	18180	17717	17235	16732	16204	15651	15071	5	1750	60	5.64	4	21 1/2	418
36	NYJDC36N8	17457	16225	14986	13674	11952			2	870	29	2.27	6	22 1/2	513
	NYJDC36P8	20531	19209	17577	15675	13656			3	870	35	3.41	6	29 1/2	533
	NYJDC36M11	14710	13417	12240	10955	9424			1 1/2	1160	34	1.70	3	12 1/2	460
	NYJDC36N11	17206	15838	14419	12900	11617	9570		2	1160	36	2.30	3	17 1/2	471
	NYJDC36P11	20144	18660	17281	15668	13872	11713		3	1160	39	3.41	3	24	513
	NYJDC36Q11	23661	22636	21494	20126	18584	16846	12359	5	1160	48	5.64	4	29 1/2	533
	NYJDC36P17	16092	15342	14585	13805	12982	12122	11267	3	1750	78	3.34	3	5	460
	NYJDC36Q17	20866	20095	19340	18598	17860	17114	16349	5	1750	81	5.77	3	11	471
NYJDC36R17	25306	24454	23636	22834	22044	21261	20481	7 1/2	1750	82	8.50	3	16 1/2	513	
42	NYJDC42N8	21343	19071	16684	14029				2	870	32	2.29	3	17 1/2	576
	NYJDC42P8	24963	22724	20030	16880				3	870	35	3.46	3	25	596
	NYJDC42N11	18747	17292	15735	14137				2	1160	44	2.28	3	6	532
	NYJDC42P11	22902	21302	19822	18340	16669	14536		3	1160	45	3.43	3	11	574
	NYJDC42Q11	28864	27122	25399	23616	21740	19738	17553	5	1160	52	5.61	3	18	596
	NYJDC42R17	29506	28522	27584	26642	25625	24563	23452	7 1/2	1750	91	8.50	3	7	574
	NYJDC42S17	33847	32800	31798	30836	29895	28955	27994	10	1750	93	11.33	3	10 1/2	596
48	NYJDC48P8	29693	27015	23678	20494	16972			3	870	45	3.45	3	13 1/2	725
	NYJDC48Q8	37210	33927	30279	26307	21262			5	870	53	5.66	3	21 1/2	768
	NYJDC48R8	42383	39285	35673	32247	29001	24103	20744	7 1/2	870	61	8.44	4	24 1/2	797
	NYJDC48Q11	32665	30812	28769	26581	24259	21944	19762	5	1160	72	5.61	3	8 1/2	728
	NYJDC48R11	40304	38335	36226	33681	31174	28738	26300	7 1/2	1160	79	8.47	3	14	766
NYJDC48S11	46174	43908	41538	38815	36331	33738	30423	10	1160	88	11.34	3	18 1/2	795	
54	NYJDC54N6	28628	25561	21740					2	680	39	2.22	4	8 1/2	970
	NYJDC54P8	33199	30361	26814	23286				3	870	57	3.34	3	7 1/2	962
	NYJDC54Q8	44593	38831	35694	31671	26990	23415		5	870	57	5.66	3	14 1/2	1007
	NYJDC54R8	50284	47605	44294	39224	32001	28111		7 1/2	870	63	8.62	3	22	1037
	NYJDC54R11	45984	43942	41683	38661	36209	33910	31077	7 1/2	1160	97	8.66	3	8 1/2	1003
NYJDC54S11	53417	50142	47357	45114	41881	38264	35935	10	1160	97	11.36	3	12	1033	
60	NYJDC60P6	38850	33201	28385					3	680	39	3.43	3	11	1270
	NYJDC60Q8	44157	39513	35878	32398	27063			5	870	62	5.55	3	7 1/2	1311
	NYJDC60R8	53423	49485	44863	40800	36029	28551		7 1/2	870	62	8.47	3	13 1/2	1346
	NYJDC60S11	55593	51668	48830	46295	44025	41196	36458	10	1160	102	11.46	3	6	1341

See page 8 for performance-table notes.

* An adjustable-pitch propeller with cast-aluminum airfoil-shaped blades is standard. The number of blades and pitch angle for each model is indicated.



ACCESSORIES



HOODED ROOF VENTILATORS

Back-Draft Dampers

Automatic or motor-operated Type S back-draft damper suitable for most applications. Heavy-duty motorized Type RP back-draft damper specifically designed for reversible airflow. Features .080 extruded aluminum blades, .125 extruded aluminum frame, and heavy-duty damper motor. No fan delay is necessary.

Filters

Model NYPS-F units include filters for mounting during installation. Filters are 2-inch thick, permanent, cleanable, and designed to handle velocities to 650 feet-per-minute to maximum temperature of 120°F. Contact your New York Blower representative for further information.



Bird Screen

Galvanized wire mesh prevents entry of birds and rodents. Not necessary on filtered units.

UPBLAST ROOF VENTILATORS

Outlet Guard

Constructed of 1-inch x 1-inch, 14-gauge galvanized wire mesh. Mounts on the top edge of the wind shroud and prevents entry of foreign objects.

Magnetic Latches

The addition of magnetic latches can minimize “damper flap” and accidental venting when unit is not in use.

Model NYJTEBC

Model NYJTEBC Upblast Roof Ventilators are available with motor out of airstream. Contact your New York Blower representative.

HOODED AND UPBLAST ROOF VENTILATORS

Safety Disconnect Switch

Prevents accidental starting. Furnished in a NEMA 3R enclosure. Mounts to the base section and is shielded from weather by the hood on hooded units. Mounting bracket and coupling for wiring through curb cap are supplied on Upblast units. Pre-wiring of switch to motor may also be specified.



Spark-Resistant Construction

For hazardous locations, can be ordered with a nonferrous blade assembly [where not normally supplied] and explosion-proof motors. Motors only qualify for Class I, Group D, and Class II, Groups F and G, hazards. Not available on Model NYJBHX.

Pre-fabricated Roof Curb

T-style 8-inch standard-height curbs are welded galvanized steel, insulated, with wood nailer. Construction to accommodate single-pitch or double-pitch roof slope also available.

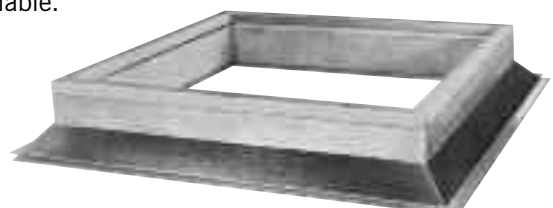

The New York Blower Company has a policy of continuous product development and reserves the right to change designs and specifications without notice.

DIMENSIONS **Not to be used for construction unless certified.**

HOODED ROOF VENTILATORS BELT-DRIVE

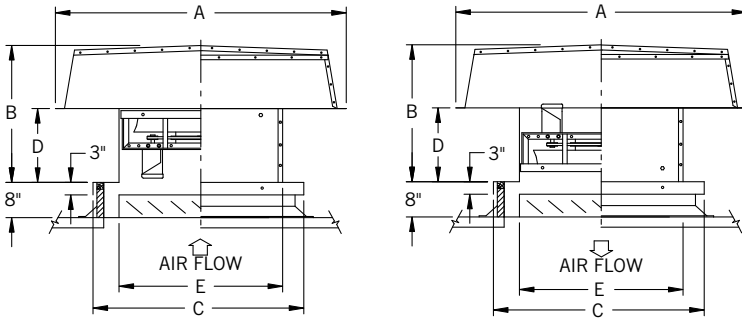

Typical exhaust

Typical supply

Fan size	DIMENSIONS [Inches]					Gauges		
	A	B	C	D	E	Hood	Base	Curb cap
24	67	38 $\frac{1}{4}$	38	20 $\frac{3}{4}$	28 $\frac{3}{8}$	20	18	14
30	78	40	44	20 $\frac{3}{4}$	34 $\frac{3}{8}$	20	18	14
36	88	41	50	20 $\frac{3}{4}$	40 $\frac{3}{8}$	20	18	14
42	98	46 $\frac{1}{2}$	56	20 $\frac{3}{4}$	46 $\frac{3}{8}$	20	16	14
48	109	55 $\frac{3}{8}$	62	23 $\frac{5}{8}$	52 $\frac{3}{8}$	18	16	14
54	118	58 $\frac{3}{8}$	68	23 $\frac{5}{8}$	58 $\frac{3}{8}$	18	14	12
60	118	58 $\frac{5}{8}$	77	23 $\frac{5}{8}$	64 $\frac{3}{8}$	18	14	12
72	127 $\frac{7}{8}$	58 $\frac{5}{8}$	89	33 $\frac{5}{8}$	80 $\frac{3}{4}$	16	12	10
84	139 $\frac{1}{2}$	62 $\frac{3}{4}$	101	33 $\frac{5}{8}$	92 $\frac{3}{4}$	16	12	10

Tolerance: $\pm \frac{1}{8}$ "

Dimension B is overall height above curb.
Dimension C is inside curb-cap flange.
Dimension D is distance from curb to hood.
Dimension E is damper net length and width,
flanges add 1 $\frac{1}{16}$ inches on all sides.

HOODED ROOF VENTILATORS DIRECT-DRIVE

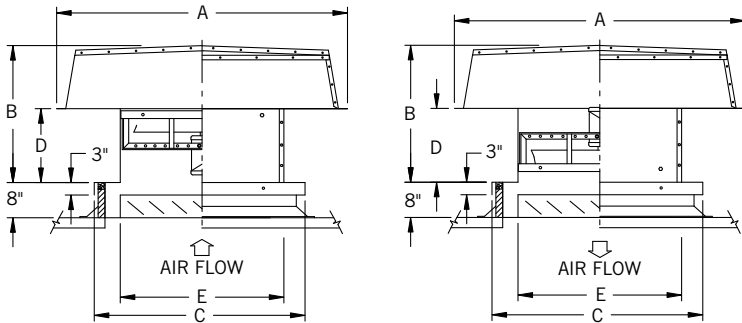

Typical exhaust

Typical supply

Fan size	DIMENSIONS [Inches]					Gauges		
	A	B	C	D	E	Hood	Base	Curb cap
24	57	33 $\frac{3}{4}$	38	20 $\frac{3}{4}$	28 $\frac{3}{8}$	20	18	14
30	67	38 $\frac{1}{2}$	44	20 $\frac{3}{4}$	34 $\frac{3}{8}$	20	18	14
36	78	41 $\frac{3}{4}$	50	20 $\frac{3}{4}$	40 $\frac{3}{8}$	20	18	14
42	88	43 $\frac{7}{8}$	56	20 $\frac{3}{4}$	46 $\frac{3}{8}$	20	16	14
48	98	51	62	23 $\frac{5}{8}$	52 $\frac{3}{8}$	18	16	14
54	109	55 $\frac{3}{8}$	68	23 $\frac{5}{8}$	58 $\frac{3}{8}$	18	14	12
60	109	55 $\frac{5}{8}$	77	23 $\frac{5}{8}$	64 $\frac{3}{8}$	18	14	12

Tolerance: $\pm \frac{1}{8}$ "

Dimension B is overall height above curb.
Dimension C is inside curb-cap flange.
Dimension D is distance from curb to hood.
Dimension E is damper net length and width,
flanges add 1 $\frac{1}{16}$ inches on all sides.

UPBLAST ROOF VENTILATORS

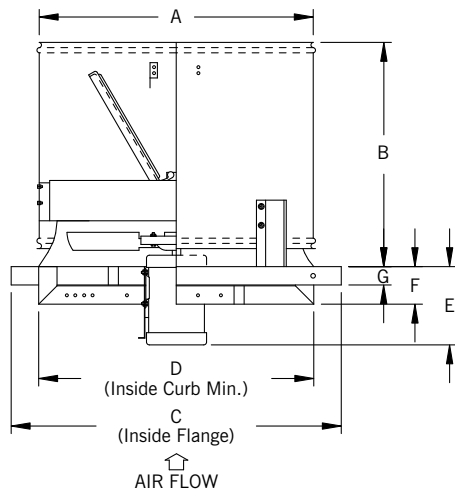

Typical belt-drive

Model size				DIMENSIONS [Inches]								Gauges			
				A	B	C	D	E				F	G	Wind shroud	Curb cap
NY JBH	NY JBHX	NY JBC	NY JDC					NY JBH	NY JBHX	NY JBC	NY JDC				
			18	23	28 $\frac{1}{4}$	32	24				10	4 $\frac{3}{4}$	2	22	14
24			24	32	29 $\frac{5}{8}$	38	30	11 $\frac{1}{2}$			12	4 $\frac{7}{16}$	2	22	14
30			30	38	34 $\frac{1}{2}$	44	36	16			12	4 $\frac{7}{16}$	2	22	14
36			36	44	34 $\frac{1}{2}$	50	42	17			15 $\frac{1}{2}$	4 $\frac{1}{4}$	2	22	12
42			42	50	39 $\frac{3}{8}$	56	48	17			18	4 $\frac{1}{4}$	2	20	12
48			48	56	39 $\frac{3}{8}$	62	54	18	20 $\frac{1}{2}$	24	20	7 $\frac{1}{8}$ *	2	20	12
	48	48	54	62	43 $\frac{3}{4}$	68	60		21	24	20 $\frac{1}{2}$	7 $\frac{5}{8}$	3	18	10
	60	60	60	68	46 $\frac{3}{4}$	77	69		21	24	20 $\frac{1}{2}$	7 $\frac{5}{8}$	3	18	10
		72		80	53 $\frac{7}{8}$	89	81			30		12 $\frac{3}{8}$	3	16	10
		84		92	62 $\frac{7}{8}$	101	93			30		12 $\frac{3}{8}$	3	16	10

* Model NYJBH Size 48 is 4 $\frac{5}{8}$ "

Tolerance: $\pm \frac{1}{8}$ "

COMPLETE SELECTION OF AIR-MOVING EQUIPMENT

The New York Blower Company offers thousands of different types, models, and sizes of air-moving equipment. Contact your nyb representative for assistance in identifying the best fan for your application.



AIR-HANDLING [AXIAL]

For the ideal handling of clean to moderately dirty airstreams. Commercial and industrial HVAC, drying and cooling systems, fume extraction, and process-heat removal are typical applications.



FIBERGLASS REINFORCED PLASTIC [FRP]

Choice of performance and duty for corrosive gas streams. Applications include chemical process, wastewater treatment, laboratory hood exhaust, and tank aeration.



DUST/MATERIAL HANDLING

Wide range of duty available with unique fan lines capable of handling light dust to heavy material. Typical applications include dust-collection and high-pressure process along with material-conveying.

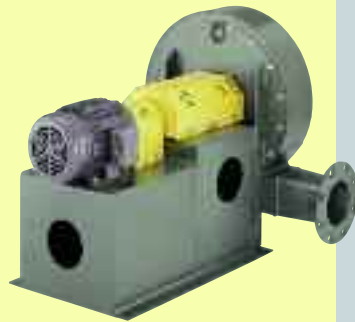

AIR-HANDLING [CENTRIFUGAL]

Designed for clean to moderately dirty gas streams. Commercial and industrial HVAC, process cooling, light material-conveying, heat removal, and dryer exhaust are just a few of the numerous sample applications

CUSTOM PRODUCTS

Designed for unique applications. Variety of configurations, temperatures, flows, and pressures. Wide range of modifications and accessories are available to meet the most demanding specifications.

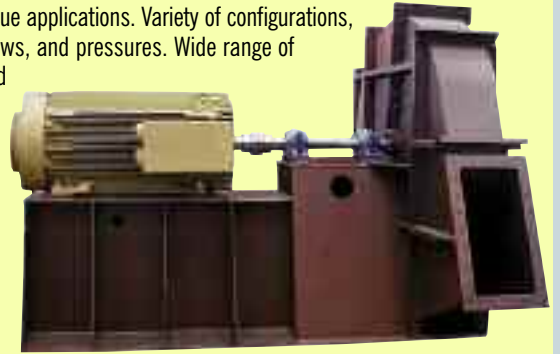

Leading the industry forward since 1889



ROOF VENTILATORS

Including both hooded and upblast ventilators, propeller fans, and centrifugal roof exhausters. These units are ideal for industrial, commercial, and institutional applications.



HEATING PRODUCTS

Industrial-duty steam unit heaters with steam heating coils are available for facility heating and process-heat transfer.



PROCESS/FAN COMPONENTS

Plug fans, plenum fans, wheels, inlet cones, and housings for a wide variety of OEM applications. Process/fan components are used in air-handling units, ovens, dryers, freezer tunnels, and filtration systems.