

VANEAXIAL FANS

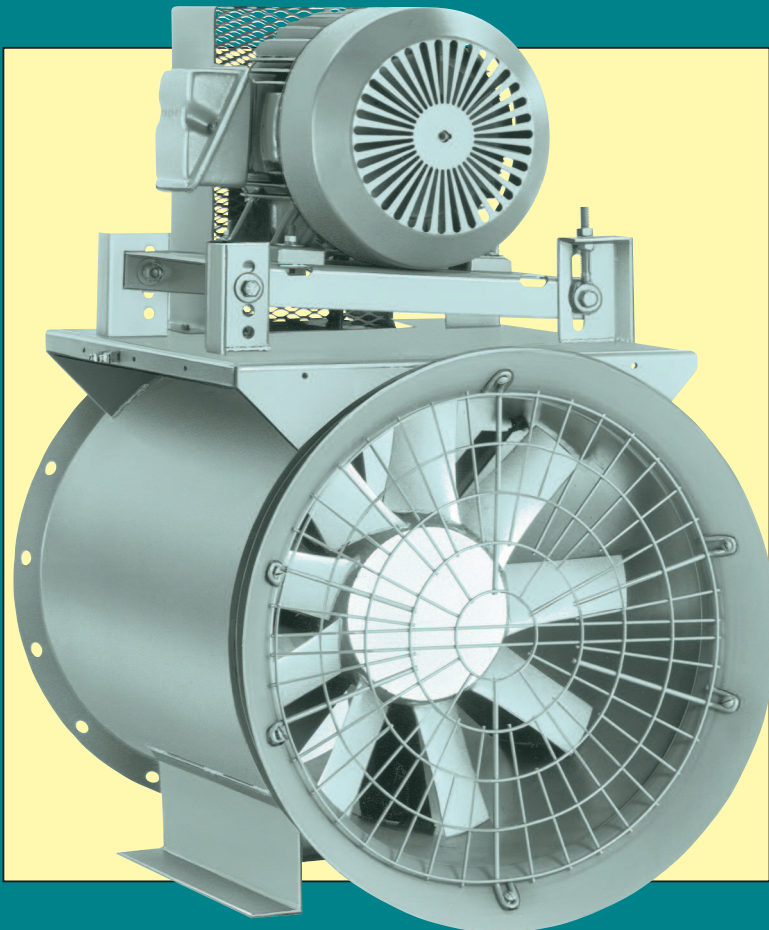

- Capacities to 100,000 CFM
- Static pressures to 5"WG
- Temperatures to 200°F.

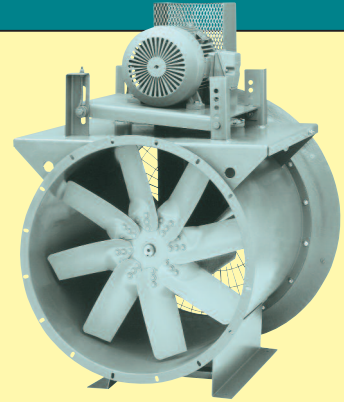

DUCT FANS

- Capacities to 60,000 CFM
- Static pressures to 2"WG

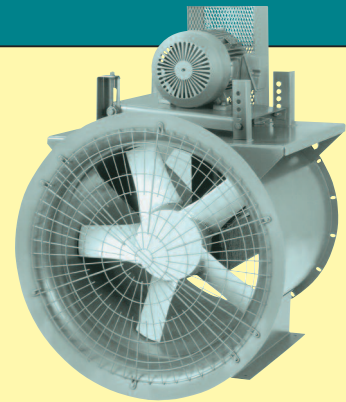

TUBEAXIAL FANS

- Capacities to 86,000 CFM
- Static pressures to 3"WG



TUBULAR ACOUSTAFOIL®

- Capacities to 140,000 CFM
- Static pressures to 14"WG



THE NEW YORK BLOWER COMPANY
7660 Quincy Street
Willowbrook, IL 60527-5530

Visit us on the Web: <http://www.nyb.com>
Phone: (800) 208-7918 Email: nyb@nyb.com

VANEAXIAL FANS

Vaneaxial Fans are designed and constructed for high pressure ventilating and industrial process applications requiring the compactness of an axial fan.

DESIGN FEATURES

- **Capacities**—to 100,000 CFM.
- **Pressures**—to 5"WG.
- **Thirteen belt-drive sizes**—12" through 60" wheel diameters.
- **Eleven direct-drive sizes**—21" through 60" wheel diameters.
- **Choice of arrangements**—direct-drive or belt-drive in five mounting positions [see page 6].
- **Precision rolled tube**—for minimum tip clearance...maximum efficiency.

CONSTRUCTION FEATURES

- **Cast aluminum wheel**—airfoil blades provide highly efficient, quiet operation for clean-air applications.
- **Heavy-gauge welded components**—provide structural strength, durability, and minimal leakage.
- **Bearings**—selected to provide long service life... 50,000 hours average minimum L-10 on Class I, 750,000 hours average minimum on Classes II and III. External lubrication fittings are standard.
- **Industrial finish**—medium-green enamel.
- **Straightening vanes**—aerodynamically designed vanes convert velocity pressure to static pressure for maximum efficiency.
- **Flanged connections**—Sizes 12 to 36 integral to housing, Sizes 42 to 60 welded bar...all flanges standard with holes.
- **Lifting eyes**—located for balanced handling.
- **Lubrication**—extended lubrication lines with external fittings provided on all belt-drive Vaneaxial Fans.
- **Adjustable motor mount**—positive screw adjustment for easy belt-tensioning.
- **Shafting**—straightened to close tolerance to minimize "run out" and ensure smooth operation.
- **Balance**—all wheels are precision-balanced prior to assembly. Fans with motors and drives mounted by **nyb** are checked at the specified running speed.
- **Inner-tube construction**—isolates bearings and drive from airstream. Removable end cover allows access to bearings and drive.
- **Taper lock hub**—for ease in wheel removal.

Arrangement 9-M
with optional inlet bell
with wire guard, motor,
drive, and belt guard.

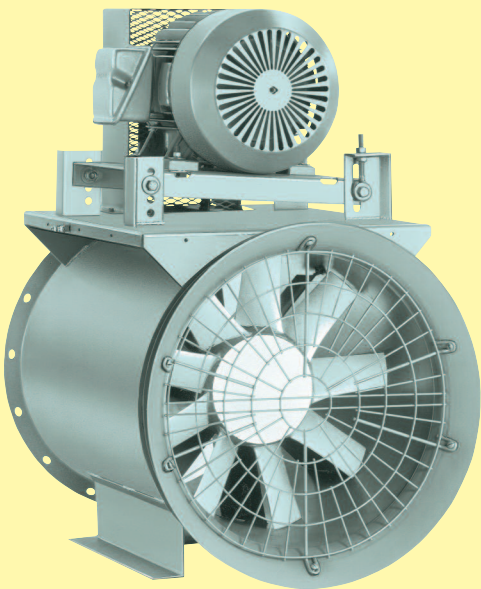

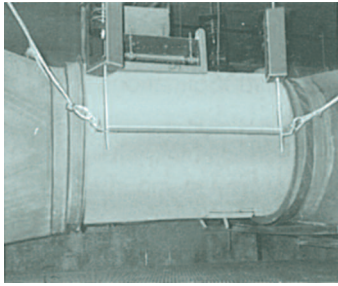

APPLICATION ADVANTAGES

New York Blower's Vaneaxial Fans are designed for high-pressure ventilation and industrial-process applications. Uses include heat, smoke, and fume removal; process drying with ambient or preheated air; comfort and process cooling and general ventilation. All applications can be handled in either supply or exhaust configurations. Numerous modifications and accessories make the Vaneaxial Fan suitable for a wide range of systems.

In applications where equipment space is at a premium, the compact flow-through design of the Vaneaxial Fan can reduce system space requirements by more than 50% over conventional centrifugal fans. The straight, in-line design eliminates the need for costly, space-consuming transitions, elbows, and inlet boxes.

Additional application advantages and installed cost savings are provided by the Vaneaxial Fan's five predesigned mounting arrangements [see page 6]. Vaneaxial Fans utilize the same housing and flange dimensions as the Tubeaxial and Duct Fan lines allowing interchangeability due to system redesign or process modification.

WHEELS DESIGNED TO MAXIMIZE PERFORMANCE

New York Blower's Vaneaxial Fans feature cast-aluminum airfoil wheels in all sizes. Generous hub-to-blade-tip diameter ratios optimize total performance while maximizing static pressure generating capability.

Direct-drive Vaneaxial wheels feature New York Blower's unique variable-pitch selection capability. Specific blade-pitch angles, unique for each application, are used in the fabrication of each direct-drive Vaneaxial wheel. Unique wheels allow the direct-drive Vaneaxial to exactly match system requirements while optimizing operating efficiency.

New York Blower's Vaneaxial Fans provide relatively large volumes of air at high static pressures. For even higher pressure requirements, see New York Blower's Tubular Acoustafoil® Fans utilizing centrifugal airfoil wheels. For systems requiring lower pressure, refer to New York Blower's Tubeaxial or Duct Fan bulletins.

ACCESSORIES AND MODIFICATIONS

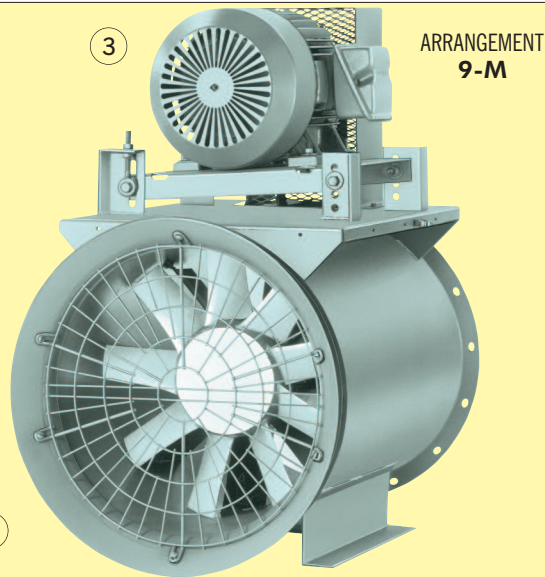

1

3

ARRANGEMENT
9-M

5

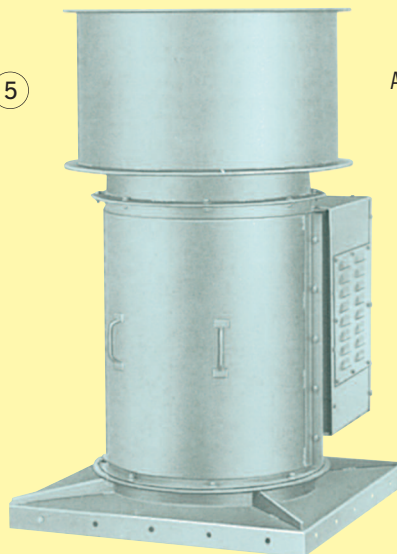

3

6

ARRANGEMENT
9-D

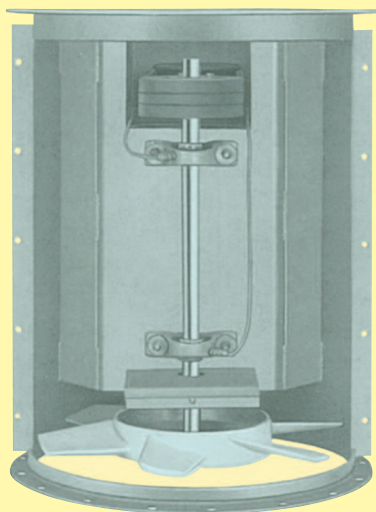

10

1. **INLET BELL WITH GUARD**—see page 5
Inlet bell minimizes losses associated with non-ducted inlet applications. Includes wire guard.
2. **VIBRATION ISOLATION**—see page 6
Rubber-in-shear or spring-type isolation mounts reduce the transmission of vibration to the mounting structure.
3. **SAFETY EQUIPMENT/WEATHER COVER**
Belt guards, inlet and outlet guards, and weather covers are available. Selection of appropriate safety accessories is the responsibility of the system designer familiar with the specific installation.
4. **COMPANION FLANGES**—not shown
Fit flush with fan inlet and outlet flanges, provided with matching hole pattern.
5. **STACK HOOD**
Stack hood with built-in back-draft dampers for outdoor exhaust applications.
6. **CURB CAP**
Gusseted cover with nailer holes on perimeter includes flange for fan mounting.
7. **DRAINS**—not shown
For horizontal mounted fans...drain located at the lowest point of the housing tube.
8. **ACCESS DOOR**—not shown
Gasketed, latch-type door swings open on hinges after turning cam levers...provides access to wheel...available in Sizes 245 and larger...inspection port available on smaller sizes.
9. **SHAFT SEAL**—not shown
Ceramic-felt seal elements encased between metal backing plate and retaining disc...elements can be easily split for field installation and maintenance...lubricated lip seals are also available.
10. **MOTORS AND DRIVES**
A wide-array of motor and drive components are available factory-mounted by **nyb**.
11. **INLET VANE DAMPER**
Bolt-on damper assembly provides volume control...for modulating systems...electric and pneumatic damper operators also available.
12. **SPARK-RESISTANT CONSTRUCTION**—not shown
AMCA B [wheel type] SRC and AMCA C [buffer type] SRC construction available on Sizes 165-605. SRC construction not available with inlet damper, inlet guard, or easy-access construction.

Protective coatings and special alloys are available to combat corrosion problems.

HOUSINGS AND STRUCTURALS

Thin film coatings [5 to 10 mil thickness]—special paints and spray coatings are available under a variety of trade names. **nyb** works with experienced coating applicators who can apply coatings to meet a wide range of requirements.

WHEELS, HOUSINGS AND STRUCTURALS

Alternate material construction—Duct Fans can be constructed of aluminum or stainless steel.

ACCESSORY PERFORMANCE

INLET BELL

Catalog ratings shown in this bulletin are for Vaneaxial Fans with free inlet and ducted outlet. When no inlet duct is used, entrance loss must be added to the static pressure calculated for the system. For bare inlets, that loss is equal to the fan velocity pressure. **Example:** 4200 FPM velocity = 1.1"WG [see Chart I at right]. Inlet bells render such loss negligible and are available at nominal cost. Sizes 125 through 485 constructed of fiberglass reinforced plastic; Sizes 545 and 605 constructed of steel.

CHART I VELOCITY PRESSURE	
Velocity [FPM]	VP
1000	.063
1400	.122
1800	.202
2200	.302
2600	.422
3000	.560
3400	.721
3800	.900
4200	1.100
4800	1.436
5000	1.560

SILENCER

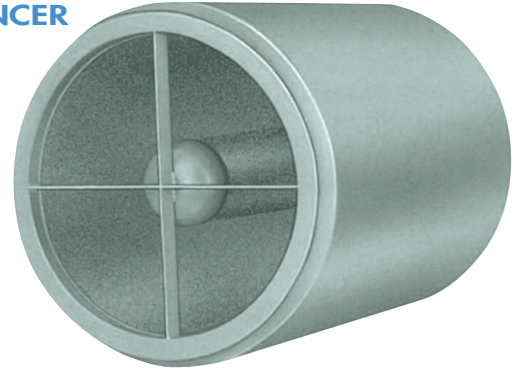

Available for all sizes of Vaneaxial Fans with matching standard flanges for either inlet or outlet applications. Silencers are available in two sizes to better match system cost as well as sound attenuation parameters. All silencers utilize heavy-welded steel construction filled with high-density acoustical absorption material. For more detailed application information and attenuation performance, refer to Engineering Supplement ES-673.

SAFETY EQUIPMENT

Safe operation of air-moving equipment is dependent on proper installation and maintenance. This includes selection and use of appropriate safety accessories for the specific installation. Such safety accessories are available from **nyb**. However, selection of the appropriate devices is the responsibility of the system designer who must be aware of the fan location, fan accessibility in the particular installation, and adjacent equipment. Neither **nyb** nor its sales representatives are in a position to make such a determination. The system designer

must consider providing guards for all exposed moving parts as well as protection from access to high velocity airstreams. Improper application, installation, maintenance, or safety guard selection can create danger to life and limb of personnel. Users and/or installers should read "Recommended Safety Practices for Air Moving Devices" as published by the Air Movement and Control Association, 30 West University Drive, Arlington Heights, Illinois 60004.

FAN TO SIZE AND DRAWINGS ON DEMAND

Fan to Size online allows customers to select fans without the need to download software on their computers or tablets. Fans can be selected by product categories, types or applications. Additionally, drawings are generated to supplement fan selections.

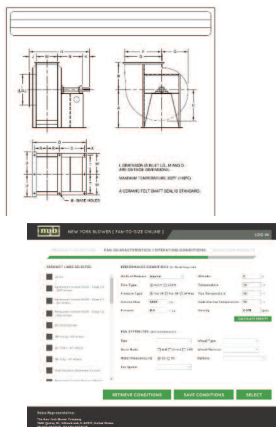

FAN TO SIZE SELECTION BENEFITS

- Compare multiple product lines.
- Metric or English units.
- Add silencers.
- Add accessories.
- Save data for future use.
- Calculate density based on rarefaction, compression, and molecular weight.

DRAWINGS ON DEMAND BENEFITS

- Generate drawing package specifically tailored to the user's application requirements.
- Fan-performance curves.
- Select fan's rotation, discharge position, motor frame size and u-base.
- Add accessories (dampers, silencers, stack hoods, curb caps)
- Installation and Maintenance Manuals.

MOUNTING ARRANGEMENTS

Arrangement 9-M with optional inlet bell wire guard, motor, drive, and belt guard.

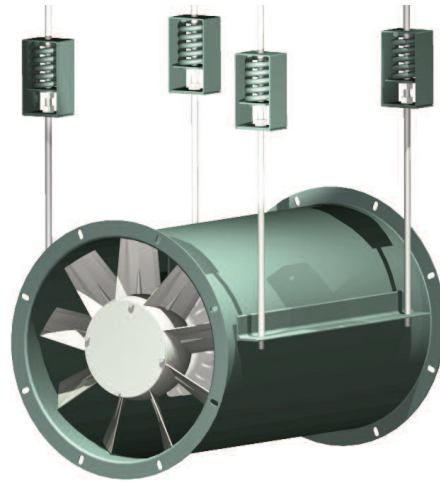
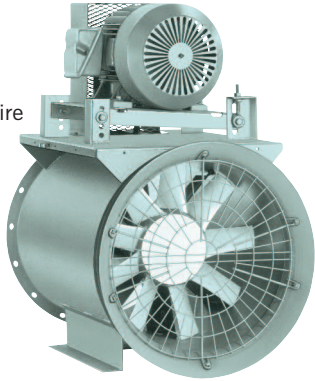

Arrangement 4-S with optional spring isolation.

ARRANGEMENTS

4-M AND 9-M WITH MOUNTING LEGS

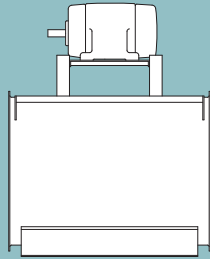

Fabricated mounting legs facilitate fan mounting on the floor, ceiling, or in a vertical position on a wall. Flange connections are standard.

9-M Mounting Positions viewed from discharge end

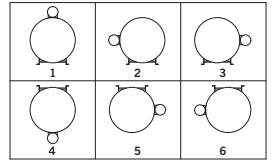

ARRANGEMENTS

4-V AND 9-V FOR VERTICAL MOUNTING

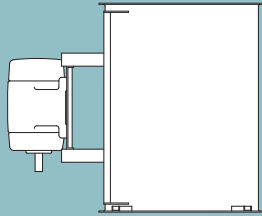

Fans are equipped with four mounting brackets suitable for floor, platform, or ceiling mounting. Motor is located on centerline between two of the four brackets on Arrangement 9. Flange connections are standard.

Mounting Positions

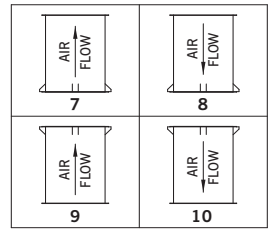

ARRANGEMENTS

4-S AND 9-S FOR SUSPENDED MOUNTING

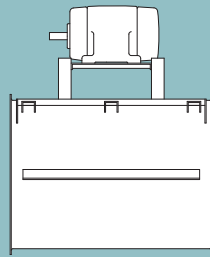

Fans for suspended mounting are equipped with side supports suitable for attachment to rods hung from the ceiling structure. Flange connections are standard.

9-S Mounting Positions

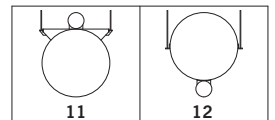

ARRANGEMENTS

4-D AND 9-D FOR DUCT MOUNTING

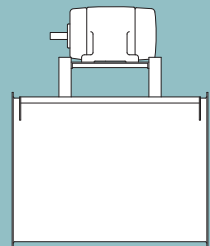

Units feature flanges on inlet and discharge for mounting to the duct work.

ARRANGEMENTS

4-R AND 9-R FOR ROOF MOUNTING

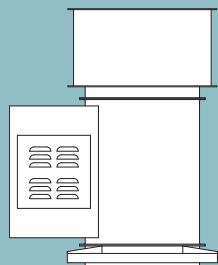

Vaneaxial Fans are available packaged with stack hoods and curb caps for outdoor exhaust applications. Arrangement 9 units also feature weather covers. Roof-mounted units have round collars extending below the curb caps for easy connection to the duct system.

MAINTENANCE MADE EASY

INDUSTRIAL DESIGNS

At New York Blower, we recognize the importance of long-term maintenance and the costs involved. All New York Blower axial fans are designed for reduced or simplified maintenance. The achievement of this goal begins with rugged industrial designs using heavy-gauge materials, welded construction, and quality components.

EXTENDED SERVICE LIFE

Components for belt-drive fans are selected with up to a 1.7 service factor for sheaves and belts. Bearings are chosen for an average minimum L-10 Life of 80,000 hours and often exceed 100,000 hours.

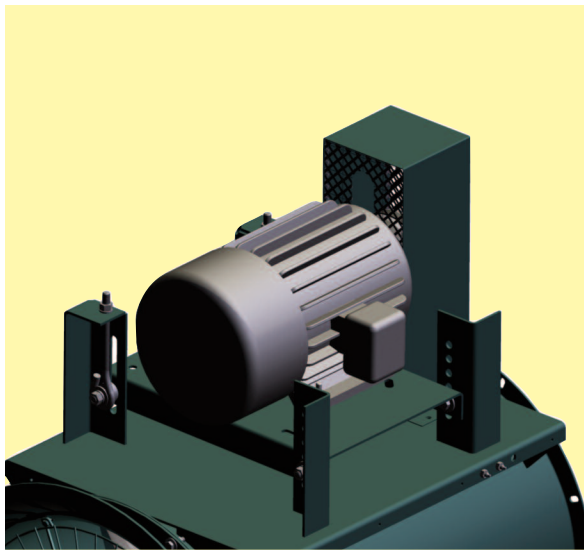
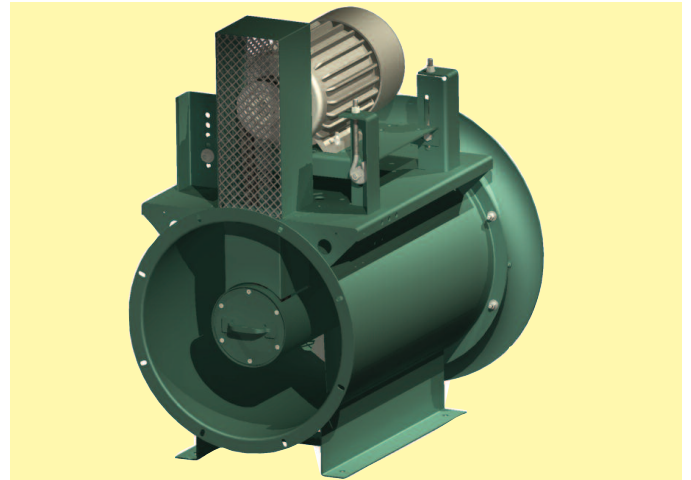

STANDARD SERVICE FEATURES

Attention to detail is an important next step in reducing maintenance expense. Features such as adjustable motor-mounting platforms for quick, sure belt-tensioning are provided as standard. Taper lock hubs are furnished for easier wheel removal. Extended bearing lubrication lines with external fittings located for ease of service are also a standard feature.

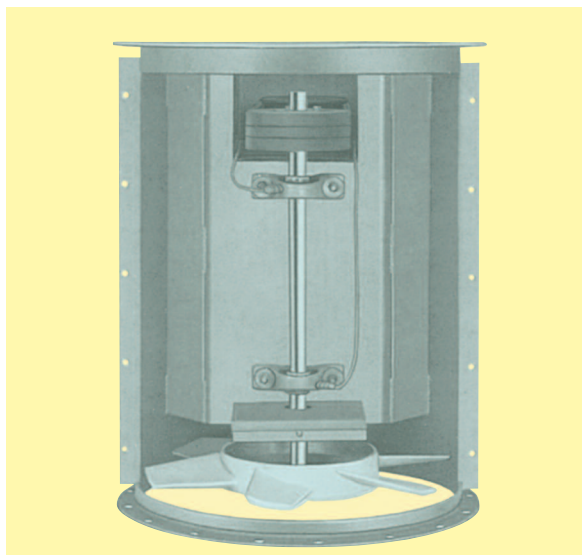

EASY ACCESS CONSTRUCTION

For more difficult applications requiring inspection or cleaning of internal components, two optional door designs are available. Access doors are recommended for less dirty systems where inspection and limited cleaning of fan internals, such as the wheel, may be desirable. They are available in Sizes 245 through 605. Inspection hand hole with cover plate available on smaller sizes. Easy-access construction is recommended for those systems requiring frequent and thorough cleaning. Wide doors open to expose wheel and motor in all direct-drive arrangements. Wheels are exposed in all belt-drive arrangements and shaft and bearings on Sizes 245 and larger where all components can be removed through the easy-access doors. Easy-access construction is available on mounting Arrangements 9-V, 9-S, 9-D, and 9-R and all Arrangement 4 fans.

How to Use Capacity Tables

For a given fan size, CFM, and static pressure, capacity tables can be used to obtain outlet velocity, fan RPM, and BHP. If capacities are at conditions other than 70°F, sea level, or standard density [.075 lb./cu. ft.], correction factors must be applied to static pressure and BHP.

PROCEDURES	STEPS	EXAMPLE: A belt-drive fan is required for 18000 CFM at 3"WG at 100°F and 6000 feet above sea level.
If conditions other than standard are involved, correct static pressure for actual altitude and temperature using Chart IV.	1	Chart IV gives a 1.33 factor for 100°F and 6000 feet. Corrected SP is 3"WG x 1.33 = 4"WG at 70°F and sea level. Select fan from capacity tables for 18000 CFM at 4"WG.
Select size, RPM, and BHP of fan from capacity table.	2	A Size 275 is selected for 18000 CFM at 4"WG at 2872 RPM and 22.7 BHP.
Check maximum safe speed of fan at operating temperatures as shown in Charts II or III.	3	From Chart II and III, the maximum safe speed is a Size 275 fan at 100°F and 2906 RPM (2965 x .98). Fan is satisfactory for operation at 100°F.
Determine actual performance at operating conditions by correcting SP and BHP.	4	Actual performance: 18000 CFM at 3"WG (4" ÷ 1.33) at 2872 RPM at 17.1 BHP (22.7 ÷ 1.33) at 100°F and 6000 feet above sea level.

MAXIMUM SAFE SPEED INFORMATION

Chart II details maximum safe speed of standard wheels at 70°F. When temperatures are involved, multiply the appropriate safe operating speed shown in Chart II by the factor shown in Chart III. Maximum operating temperature for standard Arrangement 4 fans is 105°F and for standard Arrangement 9 fans is 120°F. For temperatures above 120°F, as indicated by tinted areas in Charts III and IV select drive for a minimum of 2.0 service factor.

CHART II	Size	RPM
MAXIMUM SAFE SPEEDS FOR STANDARD ALUMINUM WHEELS AT TEMPERATURES TO 200°F Maximum safe speeds apply only to wheels operated at or below stated temperature and free of material build-up, corrosion, or wear.	12	4500
	14	4500
	16	4500
	18	4500
	21	3900
	24	3170
	27	2965
	32	2380
	36	2130
	42	1770
	48	1600
	54	1385
60	1200	

CHART III	
TEMPERATURE CORRECTION FACTORS FOR WHEEL SAFE SPEEDS	
Temp. °F	Aluminum Wheel
-50	1.00
70	1.00
100	.98
200	.98

Temperature °F	Altitude—feet above sea level												
	0	500	1000	1500	2000	3000	4000	5000	6000	7000	8000	9000	10000
-50	.77	.79	.80	.82	.83	.86	.89	.92	.96	1.00	1.04	1.08	1.12
-25	.82	.84	.85	.87	.89	.92	.95	.98	1.03	1.07	1.11	1.15	1.19
0	.87	.89	.91	.92	.94	.97	1.01	1.04	1.09	1.13	1.18	1.22	1.26
20	.91	.93	.95	.97	.98	1.02	1.06	1.09	1.14	1.18	1.23	1.27	1.32
40	.94	.96	.98	1.00	1.02	1.05	1.09	1.13	1.18	1.22	1.27	1.32	1.36
60	.98	1.00	1.02	1.04	1.06	1.10	1.14	1.18	1.23	1.27	1.32	1.37	1.42
70	1.00	1.02	1.04	1.06	1.08	1.12	1.16	1.20	1.25	1.30	1.35	1.40	1.45
80	1.02	1.04	1.06	1.08	1.10	1.14	1.18	1.22	1.28	1.33	1.38	1.43	1.48
100	1.06	1.08	1.10	1.12	1.15	1.19	1.23	1.27	1.33	1.38	1.43	1.48	1.54
120	1.09	1.11	1.13	1.16	1.18	1.22	1.26	1.31	1.36	1.42	1.47	1.53	1.58
140	1.13	1.15	1.18	1.20	1.22	1.27	1.31	1.36	1.41	1.47	1.53	1.58	1.64
160	1.17	1.19	1.22	1.24	1.26	1.31	1.36	1.40	1.46	1.52	1.58	1.64	1.70
180	1.21	1.23	1.26	1.28	1.31	1.36	1.40	1.45	1.51	1.57	1.63	1.69	1.75
200	1.25	1.28	1.30	1.33	1.35	1.40	1.45	1.50	1.56	1.63	1.69	1.75	1.81

DIRECT-DRIVE VANEAXIAL FANS

Available in Sizes 185 through 605, the direct-drive Vaneaxial Fan is ideally suited for relatively clean-air applications at temperatures to 105°F.

Elimination of the external motor mounting structure permits installation in extremely tight locations and substantial reduction in overall unit weight. The Arrangement 4 configuration virtually eliminates all regularly scheduled maintenance.

New York Blower's unique method of wheel selection and fabrication, matching blade pitch to specific airflow, pressure, and speed requirements, assures optimum performance. Each custom wheel is tested and inspected to assure conformance to design and application requirements prior to shipment.

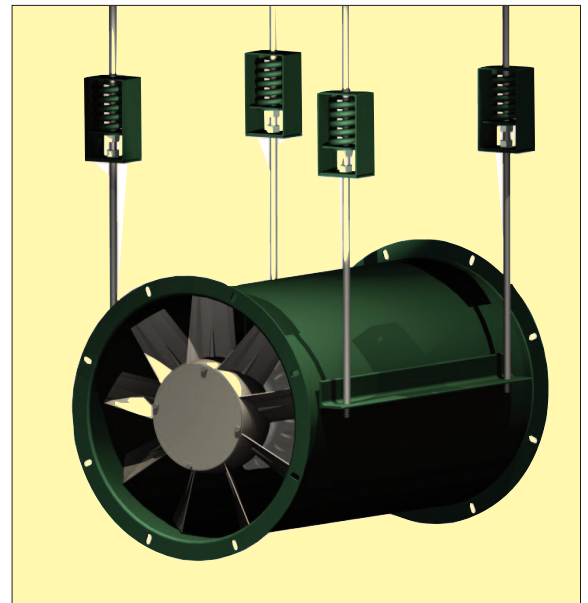

SIZE 185 DIRECT-DRIVE				1725 RPM		3500 RPM		Wheel diameter: 18"				Inlet and outlet area: 1.82 sq. ft.													
CFM	OV	1/4"SP		1/2"SP		3/4"SP		1/4"SP		1/2"SP		1"SP		1 1/2"SP		2"SP		2 1/2"SP		3"SP		3 1/4"SP			
		Angle	BHP	Angle	BHP	Angle	BHP	Angle	BHP	Angle	BHP	Angle	BHP	Angle	BHP	Angle	BHP	Angle	BHP	Angle	BHP	Angle	BHP		
2400	1319	22.5	0.20	25.4	0.31	30.9	0.53													21.7	1.98	24.3	2.43		
2800	1538	25.9	0.28	28.9	0.43	34.3	0.66													23.2	2.31	25.7	2.78		
3200	1758	29.4	0.38	32.3	0.56	37.8	0.86													24.6	2.62	27.3	3.23		
3400	1868	31.1	0.43	34.0	0.61	39.6	0.96									20.5	1.61			22.1	2.05	24.6	2.62		
																21.2	1.75			22.8	2.20	25.4	2.83		
3600	1978	32.8	0.48	35.7	0.69	41.2	1.10								20.7	1.53			21.9	1.89	23.5	2.35	26.1	3.04	
3800	2088	34.5	0.53	37.5	0.79	43.0	1.25								21.4	1.66			22.7	2.06	24.2	2.50	26.8	3.25	
4000	2198	36.3	0.62	39.2	0.90										22.1	1.79			23.4	2.20	25.0	2.67	27.6	3.48	
4200	2308	38.0	0.70	40.9	1.01										22.9	1.95			24.1	2.34	25.7	2.88	28.3	3.70	
4400	2418	39.7	0.78	42.6	1.16																				
5000	2747							20.7	1.21	21.3	1.37	22.5	1.72	23.6	2.08	24.9	2.51	26.4	3.08	27.1	3.12	28.6	3.74	29.0	3.91
5500	3022							22.9	1.55	23.5	1.72	24.6	2.07	25.8	2.56	27.1	3.12	28.6	3.74	29.0	3.91	31.2	4.58	31.6	4.49
6000	3297							24.7	1.82	25.3	2.02	26.5	2.52	27.6	3.02	28.9	3.62	30.5	4.31	31.2	4.58	33.0	5.14	33.8	5.14
								26.5	2.17	27.2	2.44	28.3	2.94	29.4	3.48	30.7	4.13	32.3	4.86	33.0	5.14	34.8	5.71	35.6	5.80
7000	3846							30.2	2.94	30.8	3.22	31.9	3.80	33.1	4.49	34.4	5.22	35.9	6.15	36.8	6.92	38.5	7.58	41.1	8.76
8000	4396							33.9	3.75	34.5	4.07	35.6	4.83	36.8	5.83	38.0	6.92	39.6	8.05	40.4	7.51	42.2	10.0	44.8	11.3
9000	4945							37.5	5.15	38.1	5.32	39.3	6.38	40.4	7.51	41.7	9.01	43.3	10.7						
10000	5495							41.8	7.04	41.8	7.04	43.0	8.51	44.1	9.95										

SIZE 215 DIRECT-DRIVE				1750 RPM		3500 RPM		Wheel diameter: 21"				Inlet and outlet area: 2.46 sq. ft.												
CFM	OV	1/4"SP		1/2"SP		3/4"SP		1/2"SP		3/4"SP		1"SP		1 1/2"SP		2"SP		2 1/2"SP		3"SP		3 1/2"SP		
		Angle	BHP	Angle	BHP	Angle	BHP	Angle	BHP	Angle	BHP	Angle	BHP	Angle	BHP	Angle	BHP	Angle	BHP	Angle	BHP	Angle	BHP	
4600	1870	30.5	0.58	33.2	0.75	36.4	1.00																	
5000	2033	32.6	0.66	35.3	0.86	38.5	1.17																	
5400	2195	34.7	0.75	37.4	1.02	40.6	1.36																	
5800	2358	36.8	0.88	39.6	1.17	42.7	1.60																	
6200	2520	39.0	1.03	41.7	1.39	44.8	1.85																	
6600	2583	41.1	1.21	43.8	1.62	46.9	2.05																	
7000	2846	43.2	1.41	45.9	1.83	49.1	2.25																	
7400	3008	45.3	1.62	48.0	2.01																			
8000	3252																							
9000	3659																							
10000	4065																							
11000	4472																							
12000	4878																							
13000	5285																							
14000	5691																							
15000	6098																							

Performance certified is for installation Type B: Free inlet, Ducted outlet. Power rating (BHP) does not include transmission losses. Performance ratings do not include the effects of appurtenances (accessories).

SIZE 365 DIRECT-DRIVE				1175 RPM		1750 RPM		Wheel diameter: 36"				Inlet and outlet area: 7.27 sq. ft.																
CFM	OV	1/4"SP		1/2"SP		3/4"SP		1"SP		1 1/4"SP		1/2"SP		1"SP		1 1/2"SP		2"SP		2 1/2"SP		3"SP						
		Angle	BHP	Angle	BHP	Angle	BHP	Angle	BHP	Angle	BHP	Angle	BHP	Angle	BHP	Angle	BHP	Angle	BHP	Angle	BHP	Angle	BHP					
10000	1348							25.9	2.31	28.5	2.98											26.9	8.90					
12000	1651			25.0	1.91	26.9	2.44	29.0	3.03	31.6	3.74											28.9	10.5					
14000	1926	25.8	1.91	27.9	2.52	30.0	3.14	32.1	3.78	34.7	4.51							26.4	8.17		26.4	8.42	26.9	8.90				
16000	2201	28.8	2.49	30.9	3.15	33.0	3.83	35.2	4.56	37.7	5.69							28.3	9.95		28.3	9.95	30.8	12.1				
18000	2476	31.9	3.11	34.0	3.83	36.1	4.72	38.3	5.82	40.8	7.12							26.5	7.89	28.4	9.74	30.3	11.5	32.8	13.7			
20000	2751	35.0	3.74	37.0	4.78	39.2	5.93	41.3	7.26	43.9	8.97							26.6	7.51	28.5	9.40	30.3	11.2	32.3	13.2	34.8	15.4	
22000	3026	38.0	4.75	40.1	5.93	42.2	7.46	44.4	9.07			26.9	7.18	28.6	8.93	30.5	10.9	32.3	12.8	34.2	14.8	36.2	17.2	36.7	18.0			
24000	3301	41.1	5.97	43.1	7.50							28.9	8.51	30.6	10.3	32.4	12.3	34.2	14.3					38.6	20.7			
26000	3576	44.1	7.41									30.9	9.87	32.5	11.7	34.4	13.9	36.2	16.6	38.2	20.0	40.6	23.9					
28000	3851											32.8	11.1	34.5	13.2	36.3	16.1	38.2	19.4	40.1	22.7	42.6	27.9					
30000	4127											34.8	12.5	36.5	15.4	38.3	18.7	40.2	22.2	42.1	26.7	44.6	32.0					
32000	4402											36.8	14.7	38.4	17.7	40.3	21.4	42.2	26.1	44.0	30.5							
34000	4677											38.7	16.8	40.4	20.4	42.3	25.2	44.1	29.8									
36000	4952											40.7	19.5	42.4	24.0	44.2	28.7											
38000	5227											42.6	22.5	44.3	27.3													
40000	5502											44.6	25.9															

SIZE 425 DIRECT-DRIVE				875 RPM		1175 RPM		Wheel diameter: 42 3/8"				Inlet and outlet area: 9.97 sq. ft.															
CFM	OV	1/4"SP		1/2"SP		3/4"SP		1"SP		1 1/4"SP		1 1/2"SP		2"SP													
		Angle	BHP	Angle	BHP	Angle	BHP	Angle	BHP	Angle	BHP	Angle	BHP	Angle	BHP												
12000	1204			20.3	1.34	22.3	1.89	25.1	2.60							23.4	5.50										
14000	1404	20.9	1.29	22.7	1.76	24.8	2.36	27.5	3.28							25.26.44											
16000	1605	23.3	1.66	25.2	2.19	27.2	2.99	29.9	3.97					21.0	3.57	22.0	4.28	21.5	4.27	23.2	5.12	27.0	7.67				
18000	1805	25.7	2.08	27.6	2.76	29.6	3.63	32.3	4.68			20.7	3.03	21.7	3.65	22.7	4.33	23.8	5.09	25.0	5.98	28.7	8.90				
20000	2006	28.2	2.59	30.0	3.34	32.0	4.29	34.8	5.39	21.7	3.14	22.5	3.69	23.5	4.37	24.5	5.09	25.5	5.99	26.8	7.15	30.5	10.2				
22000	2207	30.6	3.11	32.4	3.93	34.4	4.96	37.2	6.52	23.5	3.76	24.2	4.36	25.2	5.11	26.3	6.05	27.3	7.09	28.5	8.31	32.3	11.4				
24000	2407	33.0	3.64	34.8	4.53	36.8	5.96	39.6	7.71	25.2	4.40	26.0	5.16	27.0	6.09	28.0	7.09	29.1	8.20	30.3	9.49	34.0	12.7				
26000	2608	35.4	4.24	37.2	5.49	39.2	7.07	42.0	9.33	27.0	5.24	27.8	6.06	28.8	7.06	29.8	8.12	30.8	9.32	32.1	10.7	35.8	14.4				
28000	2808	37.8	5.12	39.6	6.48	41.7	8.52	44.4	11.0	28.8	6.07	29.5	6.97	30.5	8.05	31.6	9.20	32.6	10.5	33.8	11.9	37.6	16.5				
30000	3009	40.2	6.05	42.0	7.85	44.1	10.1			30.5	6.92	31.3	7.91	32.3	9.06	33.3	10.3	34.4	11.6	35.6	13.4	39.3	18.6				
32000	3210	42.6	7.33	44.5	9.29			32.3	7.79	33.1	8.85	34.0	10.1	35.1	11.4	36.1	13.3	37.4	15.4	37.4	15.4	41.1	21.4				
34000	3410							34.1	8.66	34.8	9.79	35.8	11.4	36.9	13.2	37.9	15.2	39.1	17.5	42.9	24.4						
36000	3611							35.8	9.80	36.6	11.3	37.6	13.1	38.6	15.0	39.7	17.1	40.9	19.9	44.6	27.5						
38000	3811							37.6	11.3	38.4	12.9	39.3	14.8	40.4	17.0	41.4	19.7	42.7	22.9								
40000	4012							39.4	12.7	40.1	14.5	41.1	16.9	42.1	19.5	43.2	22.4	44.4	25.8								
42000	4213							41.1	14.6	41.9	16.8	42.9	19.4	43.9	22.1	45.0	25.2										

SIZE 425 DIRECT-DRIVE				1770 RPM		Wheel diameter: 42 3/8"				Inlet and outlet area: 9.97 sq. ft.																	
CFM	OV	1/4"SP		1/2"SP		3/4"SP		1"SP		1 1/4"SP		1 1/2"SP		2"SP		2 1/2"SP		3"SP		3 1/2"SP		4"SP					
		Angle	BHP	Angle	BHP	Angle	BHP	Angle	BHP	Angle	BHP	Angle	BHP	Angle	BHP	Angle	BHP	Angle	BHP	Angle	BHP	Angle	BHP				
24000	2407													20.3	10.98	21.3	13.02	22.3	15.34	23.3	17.90	24.9	20.92				
27000	2708													22.1	13.49	23.0	15.66	24.10	18.13	25.1	20.90	26.6	24.94				
30000	3009	21.4	10.06	21.6	10.75	21.8	11.41	22.3	12.31	22.5	13.01	23.0	13.93	23.8	16.00	24.8	18.30	25.8	21.39	26.9	24.92	28.4	29.05				
33000	3310	23.1	12.08	23.4	12.85	23.6	13.58	24.0	14.56	24.3	15.32	24.7	16.29	25.6	18.82	26.6	21.81	27.6	25.21	28.6	28.94	30.1	33.17				
36000	3611	24.9	14.10	25.1	15.01	25.4	15.92	25.8	17.16	26.0	18.13	26.5	19.39	27.4	22.26	28.3	25.42	29.3	29.03	30.4	32.99	31.9	37.44				
39000	3912	26.7	16.81	26.9	17.89	27.1	18.90	27.5	20.24	27.8	21.29	28.2	22.63	29.1	25.69	30.1	29.05	31.1	32.94	32.1	37.17	33.6	41.71				
42000	4213	28.4	19.58	28.6	20.77	28.9	21.88	29.3	23.32	29.6	24.45	30.0	25.87	30.9	29.19	31.8	32.80	32.8	36.91	33.9	41.34	35.4	46.64				
45000	4514	30.2	22.35	30.4	23.68	30.6	24.89	31.0	26.46	31.3	27.70	31.8	29.24	32.6	32.75	33.6	33.56	34.6	40.88	35.6	46.53	37.2	53.75				
48000	4814	31.9	25.22	32.1	26.67	32.4	27.98	32.8	29.66	33.1	30.98	33.5	32.60	34.4	36.32	35.3	40.80	36.3	46.86	37.4	53.48	38.9	60.87				
51000	5115	33.7	28.09	33.9	29.66	34.1	31.08	34.5	32.85	34.8	34.26	35.3	36.30	36.1	41.42	37.1	47.06	38.1	53.48	39.2	60.44	40.7	69.20				
54000	5416	35.4	31.43	35.7	33.39	35.9	35.22	36.3	37.63	36.6	39.52	37.0	41.91	37.9	47.36	38.9	53.31	39.9	60.09	40.9	69.00						
57000	5717	37.2	36.22	37.4	38.38	37.7	40.38	38.1	42.95	38.3	44.98	38.8	47.52	39.6	58.30	40.6	60.54										
60000	6018	38.9	41.00	39.2	43.37	39.4	45.53	39.8	48.27	41.0	50.59	40.5	53.88	41.4	61.36												
63000	6319	40.7	46.64	40.9	49.52	41.2	52.21	41.6	55.72	41.9	58.49	42.3	61.98	43.2	69.94												
66000	6620	42.5	53.55	42.7	56.72	42.9	59.65	43.3	63.41	43.6	66.38	44.0	70.08														
69000	6921	44.2	60.46	44.4	63.93	44.7	67.09																				

Performance certified is for installation Type B: Free inlet, Ducted outlet. Power rating (BHP) does not include transmission losses. Performance ratings do not include the effects of appurtenances (accessories).

SIZE 485 DIRECT-DRIVE				875 RPM		1175 RPM		Wheel diameter: 48 ³ / ₈ "				Inlet and outlet area: 13.0 sq. ft.											
CFM	OV	1/4"SP		1/2"SP		1"SP		1 1/4"SP		1/4"SP		1/2"SP		3/4"SP		1"SP		1 1/2"SP		2"SP		2 1/2"SP	
		Angle	BHP	Angle	BHP	Angle	BHP	Angle	BHP	Angle	BHP	Angle	BHP	Angle	BHP	Angle	BHP	Angle	BHP	Angle	BHP	Angle	BHP
20000	1543					27.8	4.23	30.6	5.51													28.4	11.4
23000	1775					30.4	5.19	33.3	6.55													30.3	13.2
26000	2006	27.2	3.12	26.1	3.14	33.1	6.19	35.9	7.83												28.6	11.2	
29000	2238	29.8	3.87	31.9	4.80	35.8	7.37	38.6	9.57							25.7	7.40	27.8	9.89		30.5	13.0	
32000	2469	32.5	4.64	34.1	5.66	38.4	9.03	41.3	11.7			25.7	6.70	26.6	7.74	27.6	8.89	29.8	11.5	32.5	14.8	36.2	19.6
35000	2701	35.2	5.44	36.8	6.90	41.1	11.0	43.9	14.2	26.9	7.02	27.7	8.05	28.6	9.17	29.6	10.4	31.8	13.2	34.4	16.6	38.1	22.7
38000	2932	37.8	6.73	39.5	8.32	43.8	13.4	46.6	16.4	28.8	8.28	29.6	9.39	30.5	10.6	31.5	11.9	33.7	14.9	36.4	19.3	40.1	25.9
41000	3164	40.5	8.13	42.1	10.3	46.4	15.5	49.3	18.5	30.8	9.56	31.6	10.8	32.5	12.1	33.5	13.5	35.7	17.0	38.4	22.3	42.1	30.4
44000	3395	43.2	10.0	44.8	12.3	49.1	17.5			32.7	10.9	33.5	12.2	34.4	13.6	35.4	15.3	37.6	19.8	40.3	25.6	44.0	34.9
47000	3627	45.8	11.7	47.5	14.0					34.7	12.2	35.5	13.8	36.4	15.7	37.4	17.8	39.6	22.6	42.3	29.9	46.0	38.9
50000	3858	48.5	13.3							36.7	14.2	37.5	16.2	38.3	18.2	39.4	20.4	41.5	26.4	44.2	34.3	47.9	42.6
53000	4090									38.6	16.4	39.4	18.5	40.3	20.9	41.3	23.8	43.5	30.5	46.2	38.2	49.9	46.3
56000	4321									40.6	18.9	41.4	21.5	42.3	24.4	43.3	27.5	45.5	34.4	48.1	41.7		
59000	4552									42.5	22.0	43.3	24.9	44.2	28.0	45.2	31.2	47.4	37.7				
62000	4784									44.5	25.2	45.3	28.2	46.2	31.1	47.2	34.2	49.4	41.1				
65000	5015									46.4	27.9	47.2	30.9	48.1	34.0	49.2	37.3						

SIZE 545 DIRECT-DRIVE				875 RPM		1175 RPM		Wheel diameter: 54"				Inlet and outlet area: 16.5 sq. ft.												
CFM	OV	1/4"SP		1/2"SP		1"SP		1 1/2"SP		1/4"SP		1/2"SP		1"SP		2"SP		2 1/2"SP		3"SP		4"SP		
		Angle	BHP	Angle	BHP	Angle	BHP	Angle	BHP	Angle	BHP	Angle	BHP	Angle	BHP	Angle	BHP	Angle	BHP	Angle	BHP	Angle	BHP	
20000	1212							23.3	7.50												22.8	17.3	29.4	31.1
24000	1455					21.1	5.70	25.5	9.20												24.5	20.0	31.1	35.0
28000	1697					23.3	7.20	27.7	11.3							20.4	12.8	22.7	17.2	26.1	23.5	32.7	38.9	
32000	1939	21.9	5.10	22.9	6.10	25.5	8.80	30.0	13.5							22.0	15.5	24.3	20.0	27.7	27.2	34.3	42.8	
36000	2182	24.1	6.30	25.1	7.50	27.8	10.9	32.2	15.7					20.5	11.6	23.6	18.2	26.0	23.3	29.4	31.0	35.9	48.2	
40000	2424	26.3	7.80	27.3	9.30	30.0	13.0	34.4	17.9	20.3	11.9	20.8	10.7	22.2	14.0	25.2	21.1	27.6	27.1	31.0	34.9			
42000	2545	27.5	8.60	28.4	10.2	31.1	14.0	35.6	19.4	21.1	13.1	21.6	11.8	23.0	15.2	26.1	22.9	28.4	29.0	31.8	36.8			
44000	2667	28.6	9.50	29.6	11.1	32.2	15.1	36.7	21.3	22.0	14.4	22.4	12.9	23.8	16.4	26.9	24.8	29.2	30.9	32.6	38.8			
46000	2788	29.7	10.3	30.7	12.0	33.4	16.2	37.8	23.1	22.8	15.6	23.2	13.9	24.6	17.6	27.7	26.6	30.0	32.8	33.4	40.7			
48000	2909	30.8	11.2	31.8	12.9	34.5	17.2	38.9	25.0	23.6	16.9	24.0	15.0	25.4	19.0	28.5	28.5	30.9	34.8	34.3	42.7			
52000	3152	33.0	12.9	34.0	14.8	36.7	20.47	41.1	29.5	25.2	19.5	25.7	17.5	27.1	22.3	30.1	32.1	32.5	38.8	35.9	48.0			
56000	3394	35.3	14.8	36.3	17.5	38.9	24.0	43.4	34.9	26.8	22.9	27.3	20.4	28.7	25.6	31.8	36.0	34.1	42.7					
60000	3636	37.5	17.7	38.5	20.6	41.2	28.4			28.5	26.4	28.9	23.3	30.3	28.9	33.4	39.8	35.4	47.9					
64000	3879	39.7	20.6	40.7	24.2	43.4	33.5			30.1	29.8	30.6	26.3	31.9	32.3	35.0	43.7							
68000	4121	41.9	24.7	42.9	28.7					31.7	33.4	32.2	29.3	33.6	35.7									
72000	4364	44.2	28.8							33.4	36.9	33.8	32.4	35.2	39.4									

SIZE 605 DIRECT-DRIVE				875 RPM		1175 RPM		Wheel diameter: 60"				Inlet and outlet area: 20.3 sq. ft.											
CFM	OV	1/4"SP		1"SP		1 1/2"SP		1 3/4"SP		2"SP		2 1/4"SP		1/4"SP		1"SP		2"SP		3"SP		4"SP	
		Angle	BHP	Angle	BHP	Angle	BHP	Angle	BHP	Angle	BHP	Angle	BHP	Angle	BHP	Angle	BHP	Angle	BHP	Angle	BHP	Angle	BHP
25000	1232									25.3	10.2	29.3	14.7									25.2	24.6
30000	1478							25.8	10.6	27.7	12.8	30.6	16.1									26.9	29.1
35000	1724					28.4	11.1	28.2	13.2	30.0	15.4	33.0	18.8									28.6	33.6
40000	1970			25.5	9.40	28.8	13.6	30.6	15.8	32.4	18.1	35.3	21.8							25.8	25.5	30.3	38.1
45000	2217	25.3	8.30	27.9	11.7	31.2	16.2	32.9	18.4	34.8	20.8	37.7	26.3							27.4	29.9	31.9	42.8
50000	2463	27.7	10.4	30.2	14.0	33.5	18.8	35.3	21.3	37.1	25.2	40.1	30.9					25.5	23.2	29.1	34.3	33.6	47.4
55000	2709	30.1	12.5	32.6	16.4	35.9	22.1	37.7	25.7	39.5	29.6	42.4	37.4					27.2	27.3	30.8	38.7		
60000	2956	32.4	14.6	35.0	18.9	38.3	26.4	40.0	30.2	41.9	35.7					26.1	21.8	28.9	31.4	32.5	43.3		
65000	3202	34.8	16.8	37.3	22.9	40.6	31.3	42.4	36.6					25.9	19.3	27.8	25.4	30.6	35.5	34.2	47.8		
70000	3446	37.2	20.3	39.7	26.9	43.0	37.6			27.6	22.6	29.4	29.0			29.4	29.0	32.3	39.7				
75000	3695	39.5	23.9	42.1	32.5					29.2	25.9	31.1	32.7			31.1	32.7	33.9	44.0				
80000	3941	41.9	28.8	44.4	38.3					30.9	29.2	32.8	36.5			32.8	36.5	35.6	49.4				
85000	4187	44.3	34.0							32.6	32.6	34.5	40.2			34.5	40.2						
90000	4433									34.3	36.0	36.2	45.7			36.2	45.7						
95000	4680									36.0	40.7												
10000	4923									37.6	46.4												

Performance certified is for installation Type B: Free inlet, Ducted outlet. Power rating (BHP) does not include transmission losses. Performance ratings do not include the effects of appurtenances (accessories).

BELT-DRIVE VANEAXIAL FANS

Belt-drive Vaneaxial Fans are available in Sizes 126 through 606 for more aggressive airstreams or applications where temperatures may reach 200°F. Belt-drive arrangements include an inner tube and belt-well assembly that isolates bearings and drive components from airborne moisture and contaminants. In the event that system pressures or flow requirements change, belt-drive Vaneaxial Fans offer inherent performance flexibility. New performance is easily achieved by modifying readily accessible drives.

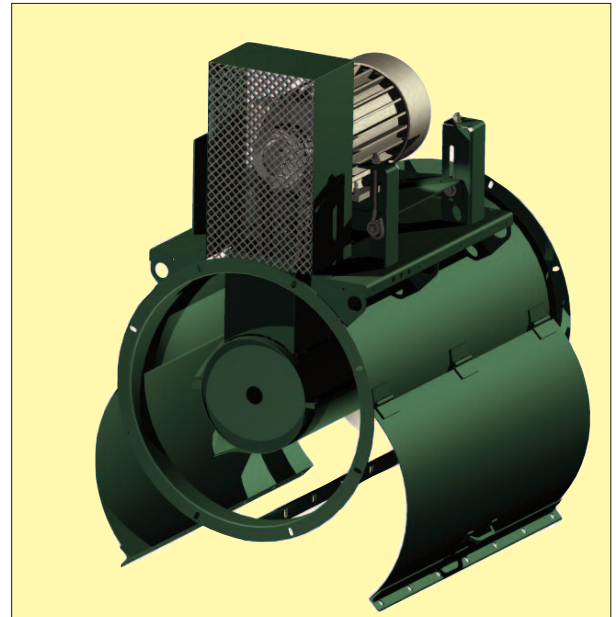

SIZE 126 BELT-DRIVE				Wheel diameter: 12"						Inlet and outlet area: 0.81 sq. ft.														
CFM	OV	1/4"SP		3/8"SP		1/2"SP		5/8"SP		3/4"SP		1"SP		1 1/4"SP		1 1/2"SP		1 3/4"SP		1 7/8"SP		2"SP		
		RPM	BHP	RPM	BHP	RPM	BHP	RPM	BHP	RPM	BHP	RPM	BHP	RPM	BHP	RPM	BHP	RPM	BHP	RPM	BHP	RPM	BHP	
1200	1481	1825	0.5	1947	0.6	2069	0.6																	
1400	1728	2055	0.6	2161	0.7	2259	0.7	2366	0.7	2479	0.8													
1600	1975	2290	0.7	2386	0.7	2472	0.8	2564	0.8	2651	0.9	2858	1.0											
1800	2222	2531	0.8	2619	0.8	2698	0.9	2779	0.9	2854	1.0	3015	1.1	3199	1.2									
2000	2469	2776	0.9	2858	1.0	2928	1.0	3006	1.1	3072	1.1	3213	1.2	3358	1.3	3527	1.5							
2100	2593	2898	1.0	2976	1.0	3046	1.1	3119	1.1	3184	1.2	3318	1.3	3460	1.4	3604	1.5	3771	1.7					
2200	2716	3022	1.0	3098	1.1	3165	1.2	3235	1.2	3299	1.3	3427	1.4	3560	1.5	3690	1.6	3840	1.8	3914	1.8			
2300	2840	3146	1.1	3218	1.2	3283	1.2	3352	1.3	3413	1.4	3538	1.5	3659	1.6	3785	1.7	3919	1.9	3990	1.9	4063	2.0	
2400	2963	3270	1.2	3341	1.3	3404	1.3	3470	1.4	3530	1.5	3652	1.6	3766	1.7	3887	1.8	4007	2.0	4065	2.0	4135	2.1	
2500	3086	3395	1.3	3464	1.4	3524	1.4	3589	1.5	3646	1.6	3765	1.7	3879	1.8	3989	1.9	4104	2.1	4159	2.1	4226	2.2	
2600	3210	3521	1.4	3586	1.5	3646	1.5	3708	1.6	3764	1.7	3876	1.8	3987	1.9	4097	2.1	4208	2.2	4261	2.3	4316	2.3	
2700	3333	3646	1.5	3711	1.6	3768	1.6	3827	1.7	3884	1.8	3993	1.9	4101	2.1	4203	2.2	4310	2.3	4361	2.4	4413	2.5	
2800	3457	3773	1.6	3835	1.7	3891	1.8	3948	1.8	4001	1.9	4110	2.0	4214	2.2	4315	2.3	4418	2.5	4467	2.5			
2900	3580	3899	1.7	3959	1.8	4013	1.9	4070	2.0	4122	2.0	4228	2.2	4328	2.3	4426	2.5							
3000	3704	4026	1.8	4084	1.9	4137	2.0	4191	2.1	4243	2.2	4344	2.3	4444	2.5									
3200	3951	4279	2.1	4334	2.2	4384	2.3	4436	2.4	4483	2.4													

SIZE 146 BELT-DRIVE				Wheel diameter: 14"						Inlet and outlet area: 1.10 sq. ft.													
CFM	OV	1/4"SP		3/8"SP		1/2"SP		3/4"SP		1"SP		1 1/4"SP		1 1/2"SP		1 3/4"SP		1 7/8"SP		2"SP		2 1/8"SP	
		RPM	BHP	RPM	BHP	RPM	BHP	RPM	BHP	RPM	BHP	RPM	BHP	RPM	BHP	RPM	BHP	RPM	BHP	RPM	BHP	RPM	BHP
2000	1818	2155	0.7	2264	0.8	2361	0.8	2572	1.0														
2400	2182	2512	0.9	2602	0.9	2684	1.0	2857	1.2	3026	1.3	3227	1.5										
2800	2545	2879	1.1	2953	1.2	3023	1.2	3170	1.4	3320	1.6	3466	1.7	3626	1.9	3790	2.1						
3000	2727	3063	1.2	3134	1.3	3199	1.4	3335	1.6	3476	1.7	3615	1.9	3748	2.1	3892	2.3	3973	2.4	4057	2.5		
3100	2818	3156	1.3	3225	1.4	3288	1.5	3419	1.6	3553	1.8	3685	2.0	3823	2.2	3962	2.4	4031	2.5	4102	2.6	4186	2.7
3200	2909	3249	1.4	3316	1.5	3377	1.5	3506	1.7	3634	1.9	3763	2.1	3893	2.3	4023	2.5	4089	2.6	4167	2.7	4228	2.8
3300	3000	3343	1.5	3409	1.6	3468	1.6	3593	1.8	3718	2.0	3840	2.2	3967	2.4	4093	2.6	4157	2.7	4222	2.8	4290	3.0
3400	3091	3437	1.6	3500	1.6	3558	1.7	3679	1.9	3798	2.1	3921	2.3	4044	2.5	4162	2.7	4223	2.8	4287	3.0	4352	3.1
3500	3182	3530	1.6	3592	1.7	3649	1.8	3765	2.0	3885	2.2	4001	2.4	4117	2.6	4239	2.8	4290	3.0	4360	3.1	4414	3.2
3600	3273	3624	1.7	3685	1.8	3741	1.9	3854	2.1	3967	2.3	4084	2.5	4196	2.7	4315	3.0	4364	3.1	4424	3.2	4484	3.3
3700	23364	3719	1.8	3777	1.9	3832	2.0	3943	2.2	4050	2.4	4163	2.6	4276	2.9	4390	3.1	4438	3.2				
3800	3455	3812	1.9	3871	2.0	3923	2.1	4031	2.3	4139	2.5	4249	2.8	4354	3.0	4465	3.3						
3900	3545	3908	2.1	3964	2.1	4014	2.2	4119	2.4	4224	2.7	4330	2.9	4439	3.2								
4000	3636	4002	2.2	4056	2.3	4107	2.4	4210	2.6	4312	2.8	4411	3.0										
4100	3727	4096	2.3	4150	2.4	4199	2.5	4301	2.7	4399	3.0	4498	3.2										
4200	3818	4192	2.4	4245	2.5	4293	2.6	4391	2.9	4486	3.1												

Performance certified is for installation Type B: Free inlet, Ducted outlet. Power rating (BHP) does not include transmission losses. Performance ratings do not include the effects of appurtenances (accessories).

SIZE 166 BELT-DRIVE

Wheel diameter: 16"

Inlet and outlet area: 1.44 sq. ft.

CFM	OV	1/4"SP		3/8"SP		1/2"SP		3/4"SP		1"SP		1 1/2"SP		1 3/4"SP		2"SP		2 1/2"SP		3"SP		3 1/2"SP		
		RPM	BHP	RPM	BHP	RPM	BHP	RPM	BHP	RPM	BHP	RPM	BHP	RPM	BHP	RPM	BHP	RPM	BHP	RPM	BHP	RPM	BHP	RPM
2400	1667	1634	0.7	1712	0.7	1784	0.8	1946	0.9															
2800	1944	1861	0.8	1928	0.9	1990	0.9	2122	1.1	2260	1.2													
3200	2222	2091	1.0	2151	1.0	2206	1.1	2317	1.3	2432	1.4	2682	1.8											
3600	2500	2326	1.1	2378	1.2	2428	1.3	2526	1.5			2833	2.1	2944	2.3									
4000	2778	2562	1.4	2610	1.5	2654	1.6	2745	1.8	2833	2.0	3015	2.4	3111	2.6	3213	2.9							
4200	2917	2681	1.5	2728	1.6	2769	1.7	2855	1.9	2941	2.1	3113	2.5	3202	2.8	3292	3.1	3487	3.6					
4400	3056	2801	1.7	2844	1.8	2885	1.9	2967	2.1	3048	2.3	3213	2.8	3296	3.0	3379	3.3	3558	3.8					
4600	3194	2920	1.8	2962	1.9	3001	2.0	3081	2.3	3158	2.5	3317	3.0	3394	3.2	3475	3.5	3639	4.1	3819	4.7			
4800	3333	3040	2.0	3081	2.1	3118	2.2	3194	2.4	3271	2.7	3419	3.2	3494	3.5	3569	3.8	3728	4.4	3892	5.0	4070	5.7	
5000	3472	3160	2.2	3200	2.3	3235	2.4	3309	2.7	3382	2.9	3524	3.5	3598	3.8	3671	4.0	3816	4.6	3974	5.3	4135	5.9	
5200	3611	3281	2.4	3319	2.5	3353	2.6	3424	2.9	3493	3.2	3633	3.7	3701	4.0	3771	4.3	3913	4.9	4056	5.6	4209	6.3	
5400	3750	3402	2.6	3438	2.8	3471	2.9	3540	3.2	3607	3.5	3740	4.0	3806	4.3	3875	4.6	4008	5.3	4145	5.9	4293	6.6	
5600	3889	3522	2.9	3557	3.0	3590	3.2	3656	3.5	3720	3.7	3850	4.3	3915	4.7	3978	5.0	4110	5.6	4243	6.3	4375	6.9	
5800	4028	3643	3.2	3678	3.3	3709	3.5	3773	3.8	3836	4.1	3959	4.7	4022	5.0	4083	5.3	4211	6.0	4338	6.6	4466	7.3	
6200	4306	3886	3.8	3918	4.0	3947	4.1	4008	4.4	4066	4.7	4185	5.4	4243	5.7	4300	6.0	4415	6.7					
6600	4583	4128	4.5	4159	4.7	4186	4.8	4243	5.1	4299	5.5	4409	6.2	4463	6.5									

SIZE 186 BELT-DRIVE

Wheel diameter: 18"

Inlet and outlet area: 1.82 sq. ft.

CFM	OV	1/4"SP		3/8"SP		1/2"SP		1"SP		1 1/2"SP		2"SP		2 1/2"SP		3"SP		3 1/2"SP		4"SP		4 1/2"SP		
		RPM	BHP	RPM	BHP	RPM	BHP	RPM	BHP	RPM	BHP	RPM	BHP	RPM	BHP	RPM	BHP	RPM	BHP	RPM	BHP	RPM	BHP	RPM
3000	1648	1524	0.7	1616	0.8	1698	0.9	2049	1.3															
3500	1923	1725	0.9	1802	1.0	1875	1.0	2173	1.5	2469	1.9													
4000	2198	1934	1.1	1998	1.1	2061	1.2	2323	1.7	2584	2.2	2849	2.8	3072	3.4									
4500	2473	2148	1.3	2203	1.4	2256	1.5	2490	2.0	2720	2.5	2958	3.1	3184	3.8	3388	4.5							
5000	2747	2364	1.6	2413	1.7	2459	1.8	2670	2.3	2879	2.9	3088	3.6	3307	4.3	3505	5.1	3699	5.8					
5500	3022	2582	1.9	2627	2.0	2668	2.2	2856	2.7	3047	3.4	3236	4.1	3428	4.8	3621	5.6	3810	6.5	3990	7.3	4156	8.1	
6000	3297	2801	2.3	2843	2.5	2880	2.6	3047	3.2	3223	3.9	3399	4.7	3570	5.4	3748	6.3	3921	7.1	4096	8.0	4260	8.9	
6500	3571	3023	2.9	3060	3.0	3095	3.2	3245	3.8	3405	4.5	3568	5.3	3729	6.1	3885	6.9	4054	7.9	4215	8.8	4376	9.8	
6750	3709	3133	3.2	3170	3.3	3204	3.5	3347	4.1	3501	4.9	3660	5.7	3812	6.5	3968	7.3	4121	8.2	4274	9.2	4440	10.2	
7000	3846	3244	3.5	3280	3.7	3312	3.8	3449	4.5	3595	5.2	3751	6.1	3899	6.9	4045	7.7	4197	8.7	4344	9.6			
7250	3984	3355	3.8	3389	4.0	3421	4.2	3553	4.8	3693	5.6	3841	6.5	3989	7.3	4130	8.2	4272	9.1	4413	10.1			
7500	4121	3467	4.2	3500	4.4	3530	4.5	3657	5.2	3791	6.0	3931	6.9	4074	7.8	4210	8.7	4346	9.6	4491	10.6			
7750	4258	3578	4.6	3610	4.8	3639	4.9	3763	5.7	3891	6.4	4027	7.3	4166	8.3	4297	9.2	4428	10.1					
8000	4396	3689	5.0	3720	5.2	3749	5.4	3869	6.1	3990	6.9	4123	7.8	4257	8.7	4383	9.7							
8500	4670	3913	6.0	3942	6.1	3969	6.3	4081	7.1	4194	7.9	4314	8.8	4442	9.8									
9000	4945	4136	7.0	4164	7.2	4190	7.4	4295	8.2	4403	9.0													

SIZE 216 BELT-DRIVE

Wheel diameter: 21"

Inlet and outlet area: 2.46 sq. ft.

CFM	OV	1/4"SP		3/8"SP		1/2"SP		3/4"SP		1"SP		1 1/2"SP		1 3/4"SP		2"SP		2 1/2"SP		3"SP		3 1/2"SP		
		RPM	BHP	RPM	BHP	RPM	BHP	RPM	BHP	RPM	BHP	RPM	BHP	RPM	BHP	RPM	BHP	RPM	BHP	RPM	BHP	RPM	BHP	RPM
3600	1463	1156	0.7	1257	0.8	1349	0.9																	
4200	1707	1286	0.8	1374	0.9	1455	1.0	1622	1.3															
4800	1951	1423	0.9	1503	1.1	1573	1.2	1718	1.4	1863	1.7													
5400	2195	1567	1.1	1636	1.2	1700	1.4	1832	1.7	1957	1.9													
6000	2439	1715	1.3	1775	1.5	1833	1.6	1950	1.9	2069	2.2	2302	3.0	2426	3.4									
6600	2683	1864	1.6	1919	1.7	1970	1.9	2080	2.2	2187	2.5	2395	3.3	2507	3.8	2609	4.3							
7200	2927	2016	1.9	2066	2.0	2112	2.2	2210	2.5	2312	2.9	2507	3.8	2601	4.2	2702	4.7	2896	5.8					
7800	3171	2168	2.2	2214	2.4	2256	2.5	2346	3.0	2441	3.4	2620	4.3	2711	4.8	2803	5.3	2976	6.3					
8400	3415	2322	2.6	2364	2.8	2404	3.0	2487	3.5	2572	3.9	2742	4.9	2826	5.4	2911	5.9	3076	6.9	3238	8.0			
9000	3659	2477	3.1	2517	3.3	2553	3.5	2629	4.0	2708	4.5	2866	5.5	2948	6.0	3026	6.5	3180	7.6	3340	8.8	3498	10.1	
9600	3902	2632	3.7	2669	3.9	2704	4.1	2776	4.6	2848	5.1	2996	6.2	3072	6.7	3148	7.3	3292	8.4	3439	9.6	3578	10.8	
10200	4146	2787	4.3	2822	4.6	2855	4.8	2922	5.3	2990	5.8	3132	7.0	3202	7.5	3272	8.1	3411	9.3	3547	10.5	3680	11.7	
10800	4390	2944	5.0	2977	5.3	3007	5.5	3072	6.1	3134	6.6	3266	7.8	3331	8.4	3398	9.0	3533	10.2	3664	11.5	3790	12.8	
11400	4634	3100	5.8	3132	6.1	3161	6.4	3220	6.9	3282	7.5	3403	8.7	3466	9.3	3531	9.9	3657	11.2	3779	12.5			
12600	5122	3414	7.6	3443	8.0	3469	8.2	3524	8.9	3579	9.5	3687	10.8	3743	11.4	3801	12.1							

Performance certified is for installation Type B: Free inlet, Ducted outlet. Power rating (BHP) does not include transmission losses. Performance ratings do not include the effects of appurtenances (accessories).

SIZE 546 BELT-DRIVE

Wheel diameter: 54"

Inlet and outlet area: 16.5 sq. ft.

CFM	OV	1/4"SP		1/2"SP		3/4"SP		1"SP		1 1/2"SP		1 3/4"SP		2"SP		2 1/2"SP		3"SP		3 1/2"SP		4"SP	
		RPM	BHP	RPM	BHP	RPM	BHP	RPM	BHP	RPM	BHP	RPM	BHP	RPM	BHP	RPM	BHP	RPM	BHP	RPM	BHP	RPM	BHP
24000	1455	432	2.2	508	3.7	580	5.4	643	7.2	749	11.4												
27500	1668	476	2.8	540	4.47	606	6.2	669	8.2	776	12.7	819	14.9										
31000	1880	522	3.6	576	5.2	636	7.2	694	9.3	799	13.9	845	16.4	888	19.0								
34500	2092	571	4.5	618	6.3	669	8.3	723	10.5	825	15.4	871	18.0	914	20.8								
38000	2304	621	5.6	661	7.5	707	9.6	753	11.8	850	17.0	896	19.8	940	22.7	1018	28.7						
41500	2517	671	7.0	707	9.0	747	11.1	790	13.5	880	18.9	922	21.7	963	24.7	1043	31.0	1117	37.8	1182	44.8	1238	51.4
45000	2729	722	8.5	755	10.6	791	12.9	828	15.4	909	20.9	950	23.9	990	26.9	1067	33.4	1140	40.5	1205	47.6	1266	55.1
48500	2941	773	10.3	803	12.6	835	14.9	869	17.5	946	23.1	981	26.2	1020	29.5	1092	36.0	1165	43.5	1231	51.0	1293	58.8
52000	3153	825	12.4	852	14.7	882	17.2	913	19.9	979	25.6	1015	28.9	1051	32.2	1121	39.1	1189	46.4	1255	54.3	1315	62.1
55500	3366	877	14.7	903	17.2	930	19.9	958	22.6	1019	28.6	1051	31.8	1085	35.2	1151	42.4	1217	50.0	1281	58.1	1342	66.4
59000	3578	929	17.4	953	20.0	978	22.7	1004	25.5	1060	31.8	1090	35.1	1121	38.7	1182	45.8	1244	53.5	1307	61.9	1365	70.3
62500	3790	982	20.3	1004	23.1	1028	26.0	1052	28.9	1103	35.3	1130	38.6	1159	42.3	1217	49.8	1275	57.6	1334	65.9		
66000	4002	1035	23.6	1056	26.5	1407	29.4	1100	32.6	1147	39.1	1173	42.7	1199	46.3	1253	53.9	1308	62.0	1363	70.3		
69500	47215	1087	27.2	1107	30.2	1128	33.4	1149	36.6	1193	43.4	1217	47.1	1240	50.6	1291	58.4	1343	66.7				
73000	4427	1140	31.3	1159	34.4	1178	37.6	1198	41.0	1240	48.0	1262	51.7	1284	55.4	1332	63.6	1379	71.8				
76500	4639	1193	35.6	1211	38.9	1229	42.4	1246	45.8	1288	53.1	1308	56.8	1329	60.7	1373	68.9						

SIZE 606 BELT-DRIVE

Wheel diameter: 60"

Inlet and outlet area: 20.3 sq. ft.

CFM	OV	1/4"SP		1/2"SP		3/4"SP		1"SP		1 1/2"SP		1 3/4"SP		2"SP		2 1/2"SP		3"SP		3 1/2"SP		4"SP	
		RPM	BHP	RPM	BHP	RPM	BHP	RPM	BHP	RPM	BHP	RPM	BHP	RPM	BHP	RPM	BHP	RPM	BHP	RPM	BHP	RPM	BHP
31790	1566	407	2.8	466	4.6	521	6.5	575	8.6														
35606	1754	441	3.5	496	5.47	546	7.4	594	9.6	695	15.0	743	17.9										
39402	1941	477	4.3	527	6.4	574	8.6	619	10.9	707	16.1	752	19.1	797	22.4								
43198	2128	514	5.2	560	7.5	604	9.8	645	12.2	727	17.6	765	20.4	807	23.8	889	30.9						
46994	2315	551	6.3	593	8.7	635	11.2	675	13.8	749	19.3	786	22.3	824	25.5	898	32.5	974	40.5				
50811	2503	590	7.6	628	10.0	667	12.7	705	15.6	775	21.3	809	24.3	844	27.6	912	34.6	981	42.2	1053	51.2	1121	60.5
54607	2690	628	9.1	664	11.6	701	14.5	737	17.5	803	23.5	837	26.8	866	29.8	930	36.9	993	44.4	1061	53.4	1124	62.4
58403	2877	660	10.7	700	13.4	734	16.3	769	19.5	833	25.9	865	29.3	894	32.7	952	39.7	1013	47.5	1072	55.8	1135	65.3
62199	3064	708	12.6	737	15.4	769	18.4	801	21.7	864	28.6	893	32.0	921	35.4	978	42.8	1032	50.4	1089	58.9	1146	68.1
65995	3251	748	14.7	774	17.5	804	20.7	835	24.2	894	31.3	923	34.9	950	38.5	1004	46.2	1057	54.2	1107	62.3	1162	71.7
69791	3438	788	17.1	812	20.0	841	23.4	869	26.9	926	34.2	9583	38.0	980	41.9	1032	49.8	1082	67.9	1131	66.4		
73608	3626	828	19.7	852	22.8	877	26.1	904	29.0	959	37.6	985	41.4	1012	45.7	1061	53.8	1111	62.4	1157	70.9		
77404	3813	869	22.6	891	25.8	915	29.3	940	32.9	992	41.0	1017	45.1	1042	49.3	1092	58.0	1138	66.8				
81200	4000	909	25.8	930	29.1	952	32.6	976	36.4	1026	44.9	1050	49.1	1075	53.5	1121	62.2	1167	71.5				
84996	4187	950	29.3	969	32.6	991	36.3	1013	40.3	1060	48.8	1083	53.2	1107	57.7	1154	67.3						
88792	4374	991	33.1	1009	36.5	1029	40.4	1050	44.4	1095	53.1	1117	57.7	1141	62.6	1184	71.9						

Performance certified is for installation Type B: Free inlet, Ducted outlet. Power rating (BHP) does not include transmission losses. Performance ratings do not include the effects of appurtenances (accessories).

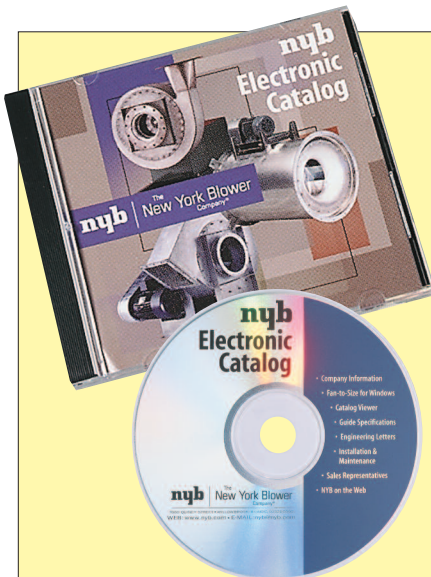

ELECTRONIC CATALOG

A complete New York Blower Catalog on one CD. No more manual calculations and bulky product catalogs. A critical tool for all system-designers and engineers who select and specify air-moving equipment.

SELECTION BENEFITS

- Fast, accurate fan selection.
- Automatic altitude, temperature, and density corrections.
- Sound levels by octave band.
- Fan-performance curves.
- Multiple model and size choices.
- Metric or English units.

CATALOG CONTENTS

- Fan-selection program.
- Complete product catalog in PDF including drawings, dimensions, and design specifications.
- Sample guide specifications.
- New York Blower Engineering Letters.
- Installation and Maintenance Manuals.
- Listing of New York Blower representatives.

To obtain your copy of New York Blower's Electronic Catalog contact your local New York Blower representative or go to www.nyb.com and click on *Selection Software*.

MATERIAL SPECIFICATIONS

Dimensions in inches. Weights in pounds. WR² in lb.-ft.². Tolerance: ±1/8"

Size	No. of blades	Wheel weight	Wheel WR ²	Bushing type	Shaft diameter	Bearings	Approximate bare fan weight						Housing gauge
							9-M	9-R	9-S, 9-V, 9-D	4-M	4-R	4-S, 4-V, 4-D	
125	6	10.3	0.8	P1	1 3/16	B	114	250	117	—	—	—	10
145	6	11.3	1.3	P1	1 3/16	B	123	264	125	—	—	—	10
165	6	13.3	3.0	P1	1 7/16	D	185	361	179	—	—	—	10
185	9	14.3	4.0	P1	1 7/16	D	196	382	190	119	280	112	10
215	9	15.0	5.0	P1	1 7/16	D	218	422	209	144	310	135	10
245	9	25.3	13	P1	1 7/16	F	305	554	291	198	399	184	10
275	9	27.3	19	P1	1 7/16	F	349	642	333	222	462	205	10
325	9	59.5	46	Q1	1 5/16	F	491	879	470	295	620	274	10
365	9	63.5	67	Q1	1 5/16	F	535	958	509	339	690	313	10
425	9	121.5	150	Q1	2 3/16	F	724	1243	687	449	872	411	10
485	9	128.5	212	Q1	2 3/16	F	788	1371	747	507	988	466	10
545	9	233.5	800	R1	2 7/16	F	1113	1965	1064	735	1467	685	7
605	9	242.5	1000	R1	2 7/16	F	1187	2133	1133	809	1627	755	7

Bearing types: B-Dodge D-Lok F-DL D-Dodge D-Lok F-DLM F-Link-Belt 22400 Series. Sizes 12-36:Flange bearings; Sizes 42-60:pillow-block
nyb reserves the right to substitute bearings of equal quality. Wheel weight includes bushing.

MOTOR SIZE CAPABILITY

Size	Arrangement 9		Arrangement 4	
	Maximum C-[N-W]	Maximum frame size	Maximum C-[N-W]	Maximum frame size
125	13	182T	—	—
145	13	184T	—	—
165	20 3/4	215T	—	—
185	20 3/4	254T	25 1/4	215T
215	20 3/4	256T	25 1/4	215T
245	23	256T	30 1/2	125T
275	25 3/4	286T	30 1/2	256T
325	27	364T	31	215T
365	27	365T	31	286T
425	27 3/4	365T	32 3/8	326T
485	27 3/4	365T	32 3/8	365T
545	30 3/4*	365T	41 3/8	365T
605	30 3/4*	365T	41 3/8	365T

Arrangement 9 maximums are with or without weather cover. *Longer motors will extend beyond fan inlet; weather covers not available.

FAN FLANGE DIMENSIONS

Size	Flange gauge	Fan ID	Bolting circle			Flange OD	Flange holes*	
			Min.	Center	Max.		No.	Size†
125	10	12 1/4	—	14	—	14 3/4	8	7/16
145	10	14 1/4	—	16	—	16 3/4	8	7/16
165	10	16 1/4	—	18	—	18 3/4	8	7/16
185	10	18 1/4	19 5/8	20	20 3/8	21 1/4	8	7/16 x 13/16
215	10	21 1/4	22 5/8	23	23 3/8	24 1/4	8	7/16 x 13/16
245	10	24 3/8	25 3/4	26 1/8	26 1/2	27 3/8	8	7/16 x 13/16
275	10	27 3/8	28 3/4	29 1/8	29 1/2	30 3/8	8	7/16 x 13/16
325	10	32 1/2	33 7/8	34 1/4	34 5/8	35 1/2	16	7/16 x 13/16
365	10	36 1/2	38	38 3/8	38 3/4	40 1/2	16	7/16 x 13/16
425	10	42 3/4	45	45	45 5/8	47 1/8	16	9/16 x 1
485	10	48 3/4	50 3/4	51	51 5/8	53 1/8	16	9/16 x 1
545	7	55	57	57 3/8	57 7/8	59 1/2	16	9/16 x 1
605	7	61	63	63 3/8	63 7/8	65 1/2	16	9/16 x 1

*Holes spaced equally, straddling centerline. †Sizes 18-60 have slotted holes.

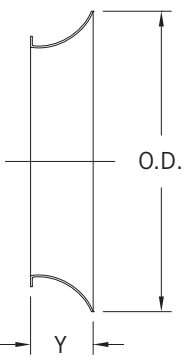
INLET BELL DIMENSIONS	Size	Y	O.D.
		125	2 1/8
	145	2 1/2	19
	165	3	21 3/4
	185	3 1/4	24 1/4
	215	3 3/4	28 1/4
	245	4 1/8	32 1/8
	275	4 3/4	36 3/8
	325	5 3/4	43 1/2
	365	6 1/4	48 1/2
	425	7 1/4	56 3/4
	485	8 1/4	64 3/4
	545	9 1/4	73
	605	10 1/4	81

INLET VANE DAMPER DIMENSIONS	Size	X
		125
	145	9
	165	9
	185	9
	215	9
	245	9
	275	9
	325	9
	365	9
	425	10
	485	10
	545	10
	605	10

DIMENSIONS

Dimensions should not be used for construction unless certified. See page 6 for available mounting positions. Note motor size capability on page 14. Tolerance: $\pm 1/8''$.

ARRANGEMENTS 4-V AND 9-V

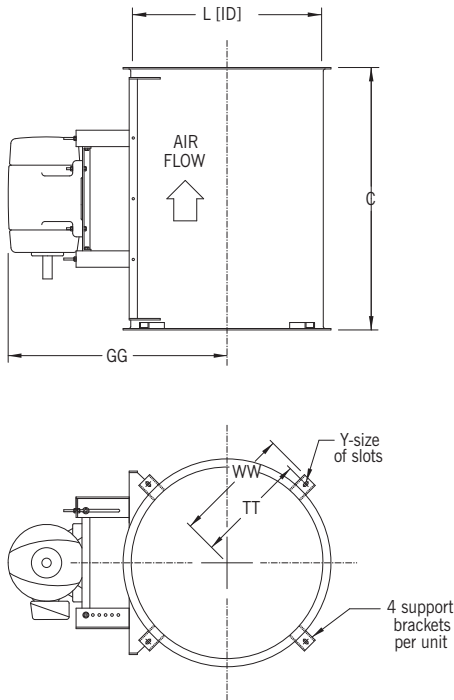

ARRANGEMENTS 4-M AND 9-M, 4-S AND 9-S, 4-D AND 9-D

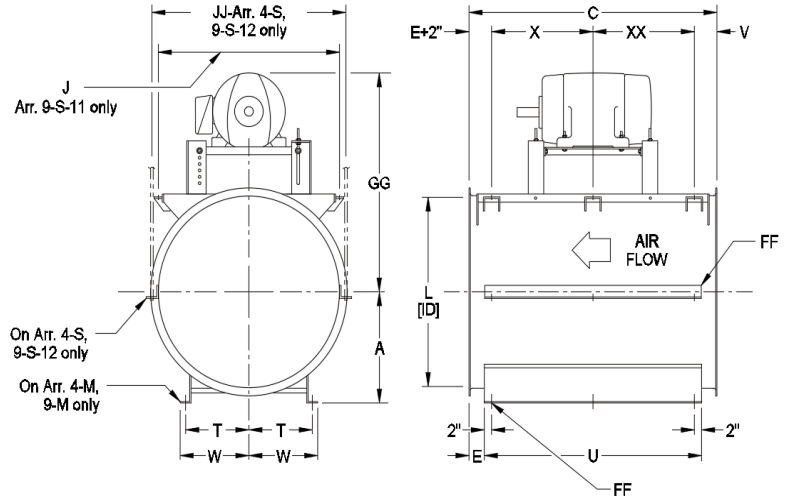

ARRANGEMENTS 4-R AND 9-R [roof-mounted] with exhaust-type stack hood.

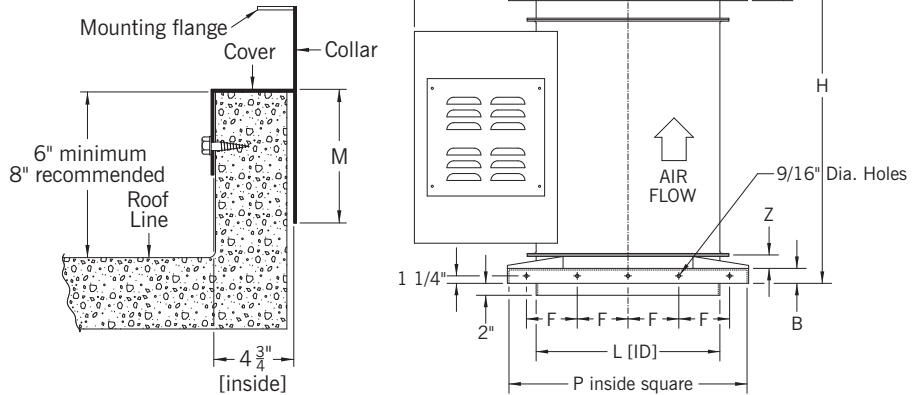

DIMENSIONS [INCHES]

Size	A	B	C	E	F	FF*	G	GG [max.]	H	J	JJ	L	M	P	R	S	T	TT	U	V	W	WW	Y
125	8 ³ / ₄	2 ¹ / ₂	25	3 ¹ / ₄	4 ¹ / ₂	9 ¹ / ₁₆	25 ¹ / ₄	23 ⁵ / ₈	46 ³ / ₄	19 ⁵ / ₈	14 ¹ / ₄	12 ¹ / ₄	4 ¹ / ₂	22	14	17 ¹ / ₄	4 ¹ / ₂	9 ³ / ₈	18 ¹ / ₂	4 ¹ / ₄	5 ¹ / ₂	10 ⁵ / ₈	9 ¹ / ₁₆ x1
145	9 ³ / ₄	2 ¹ / ₂	25	3 ¹ / ₄	4 ¹ / ₂	9 ¹ / ₁₆	26 ¹ / ₄	26	47 ³ / ₄	19 ⁵ / ₈	16 ¹ / ₄	14 ¹ / ₄	4 ¹ / ₂	24	15	19 ¹ / ₄	5 ¹ / ₂	10 ³ / ₈	18 ¹ / ₂	4 ¹ / ₄	6 ¹ / ₂	11 ⁵ / ₈	9 ¹ / ₁₆ x1
165	11 ¹ / ₄	2 ¹ / ₂	32	3 ¹ / ₄	5	9 ¹ / ₁₆	27 ¹ / ₄	27	55 ³ / ₄	19 ⁵ / ₈	18 ³ / ₄	16 ¹ / ₄	4 ¹ / ₂	26 ¹ / ₈	16	21 ¹ / ₄	6 ¹ / ₄	11 ³ / ₈	25 ¹ / ₂	11 ¹ / ₄	7 ¹ / ₂	12 ⁵ / ₈	9 ¹ / ₁₆ x1
185	12 ¹ / ₂	2 ¹ / ₂	32	3 ¹ / ₄	5 ¹ / ₂	9 ¹ / ₁₆	28 ¹ / ₂	28	57 ³ / ₄	19 ⁵ / ₈	20 ³ / ₄	18 ¹ / ₄	4 ¹ / ₂	28 ¹ / ₈	18	23 ¹ / ₄	6 ³ / ₄	12 ³ / ₈	25 ¹ / ₂	11 ¹ / ₄	8	13 ⁵ / ₈	9 ¹ / ₁₆ x1
215	14 ¹ / ₂	2 ¹ / ₂	32	3 ¹ / ₄	6	9 ¹ / ₁₆	29 ³ / ₄	29 ¹ / ₂	60 ³ / ₄	19 ⁵ / ₈	23 ³ / ₄	21 ¹ / ₄	4 ¹ / ₂	31 ¹ / ₈	21	26 ¹ / ₄	7 ⁷ / ₈	13 ⁷ / ₈	25 ¹ / ₂	11 ¹ / ₄	9 ¹ / ₈	15 ¹ / ₈	9 ¹ / ₁₆ x1
245	16 ¹ / ₂	2 ¹ / ₂	38	3 ¹ / ₄	7	9 ¹ / ₁₆	37 ³ / ₄	36 ¹ / ₈	73 ³ / ₄	24 ⁷ / ₈	28 ¹ / ₈	24 ³ / ₈	4 ¹ / ₂	34 ¹ / ₄	23	29 ³ / ₈	9	15 ¹ / ₂	31 ¹ / ₂	9 ¹ / ₂	10 ¹ / ₄	16 ³ / ₄	9 ¹ / ₁₆ x1
275	19	2 ¹ / ₂	38	3 ¹ / ₄	8	9 ¹ / ₁₆	39 ¹ / ₄	37 ⁵ / ₈	75 ³ / ₄	24 ⁷ / ₈	31 ¹ / ₈	27 ³ / ₈	4 ¹ / ₂	37 ¹ / ₄	25	32 ³ / ₈	10 ¹ / ₄	17	31 ¹ / ₂	9 ¹ / ₂	11 ¹ / ₂	18 ¹ / ₄	9 ¹ / ₁₆ x1
325	22 ¹ / ₄	3	40	4 ¹ / ₄	9	9 ¹ / ₁₆	41 ³ / ₄	40 ¹ / ₄	80 ¹ / ₄	24 ⁷ / ₈	36 ¹ / ₄	32 ¹ / ₂	5	41 ³ / ₄	26	37 ¹ / ₄	11 ³ / ₄	20 ³ / ₈	31 ¹ / ₂	11 ¹ / ₂	13 ¹ / ₄	21 ⁷ / ₈	3 ⁴ / ₁₆ x1 ¹ / ₂
365	24 ³ / ₄	3	40	4 ¹ / ₄	10 ¹ / ₂	9 ¹ / ₁₆	43 ³ / ₄	42 ¹ / ₄	85 ¹ / ₄	24 ⁷ / ₈	40 ¹ / ₄	36 ¹ / ₂	5	46 ³ / ₈	31	41 ¹ / ₂	13 ¹ / ₂	22 ³ / ₈	31 ¹ / ₂	11 ¹ / ₂	15	23 ⁷ / ₈	3 ⁴ / ₁₆ x1 ¹ / ₂
425	28 ³ / ₄	3	43	4 ¹ / ₄	12	3 ⁴ / ₁₆	51	47 ⁵ / ₈	91 ¹ / ₄	43	46 ¹ / ₂	42 ³ / ₄	5	52 ⁵ / ₈	34	47 ³ / ₄	15	25 ¹ / ₂	34 ¹ / ₂	4 ¹ / ₂	16 ¹ / ₂	27	3 ⁴ / ₁₆ x1 ¹ / ₂
485	32 ³ / ₄	3	43	4 ¹ / ₄	13	3 ⁴ / ₁₆	54	50 ⁵ / ₈	97 ¹ / ₄	43	52 ¹ / ₂	48 ³ / ₄	5	58 ⁵ / ₈	40	53 ³ / ₄	16 ³ / ₄	28 ¹ / ₂	34 ¹ / ₂	4 ¹ / ₂	18 ¹ / ₄	30	3 ⁴ / ₁₆ x1 ¹ / ₂
545	37	3	47	4 ¹ / ₄	14	3 ⁴ / ₁₆	59 ¹ / ₄	53 ³ / ₄	104 ¹ / ₄	45 ³ / ₄	59 ⁷ / ₈	55	5	64 ⁷ / ₈	43	60	18 ³ / ₄	32 ¹ / ₄	38 ¹ / ₂	5 ¹ / ₄	20 ¹ / ₄	33 ³ / ₄	1x2
605	41	3	47	4 ¹ / ₄	14 ¹ / ₂	3 ⁴ / ₁₆	62 ¹ / ₄	56 ³ / ₄	108 ¹ / ₄	45 ³ / ₄	65 ⁷ / ₈	61	5	70 ⁷ / ₈	47	66	20 ³ / ₄	35 ¹ / ₄	38 ¹ / ₂	5 ¹ / ₄	22 ¹ / ₄	36 ³ / ₄	1x2

*FF: Mounting hole size; Sizes 125-485 use two holes per side; Sizes 545 and 605 use three holes per side.

Dimensions X and XX pertain to Sizes 545 and 605 only: X = 17¹/₄", XX = 18¹/₄". Z = 2" on Sizes 125-225, 3" on Sizes 325-605.

The New York Blower Company has a policy of continual product improvement and reserves the right to change designs and specifications without notice.

COMPLETE SELECTION OF AIR-MOVING EQUIPMENT

The New York Blower Company offers thousands of different types, models, and sizes of air-moving equipment. Contact your nyb representative for assistance in identifying the best fan for your application.

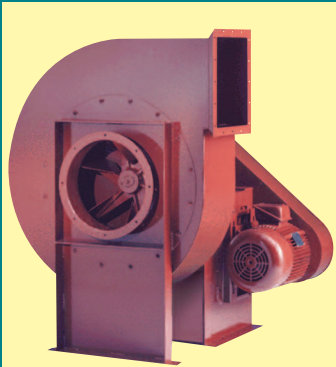

DUST/MATERIAL HANDLING

Wide range of duty available with unique fan lines capable of handling light dust to heavy material. Typical applications include dust-collection and high-pressure process along with material-conveying.

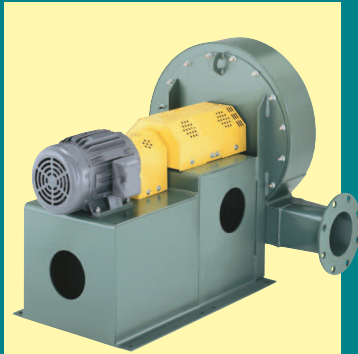

AIR-HANDLING [CENTRIFUGAL]

Designed for clean to moderately dirty gas streams. Commercial and industrial HVAC, process cooling, light material-conveying, heat removal, and dryer exhaust are just a few of the numerous sample applications

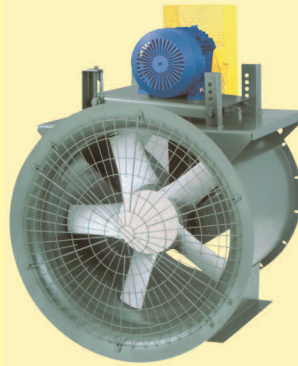

AIR-HANDLING [AXIAL]

For the ideal handling of clean to moderately dirty airstreams. Commercial and industrial HVAC, drying and cooling systems, fume extraction, and process-heat removal are typical applications.



FIBERGLASS REINFORCED PLASTIC [FRP]

Choice of performance and duty for corrosive gas streams. Applications include chemical process, wastewater treatment, laboratory hood exhaust, and tank aeration.

CUSTOM PRODUCTS

Designed for unique applications. Variety of configurations, temperatures, flows, and pressures. Wide range of modifications and accessories are available to meet the most demanding specifications.

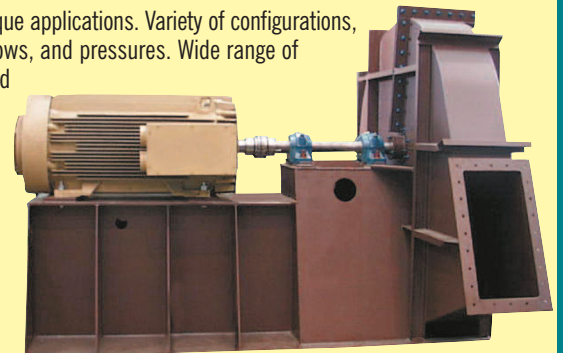

Leading the industry forward since 1889



ROOF VENTILATORS

Including both hooded and upblast ventilators, propeller fans, and centrifugal roof exhausters. These units are ideal for industrial, commercial, and institutional applications.



HEATING PRODUCTS

Industrial-duty steam unit heaters with steam heating coils are available for facility heating and process-heat transfer.

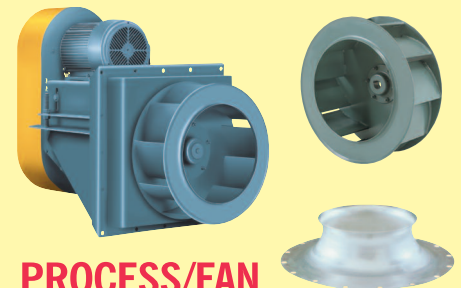

PROCESS/FAN COMPONENTS

Plug fans, plenum fans, wheels, inlet cones, and housings for a wide variety of OEM applications. Process/fan components are used in air-handling units, ovens, dryers, freezer tunnels, and filtration systems.